

- NOTES:
1. COATING:
BBAR (850 - 1500nm)
 2. TRANSMITTED WAVEFRONT ERROR, RMS:
VERTICAL: 0.15λ @ 525nm
HORIZONTAL: 0.50λ @ 525nm
 3. RoHS: COMPLIANT

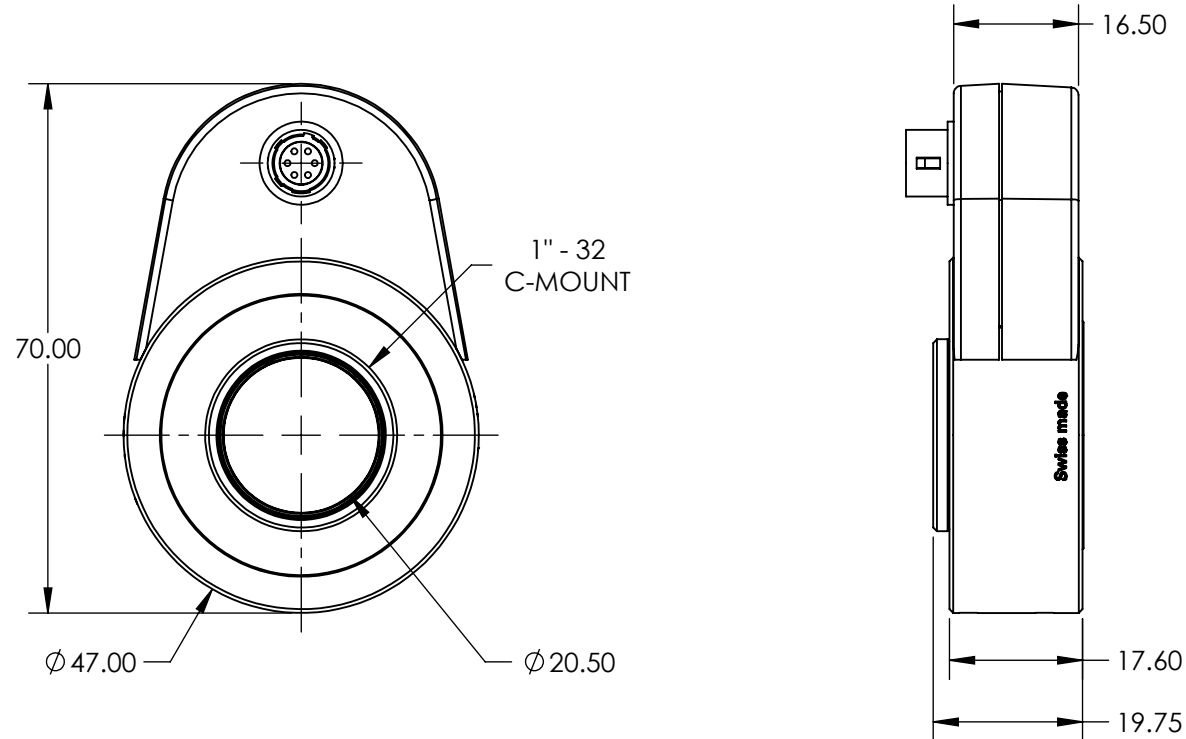
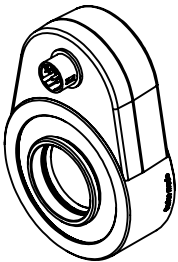

**FOR INFORMATION ONLY:
DO NOT MANUFACTURE
PARTS TO THIS DRAWING**

SPECIFICATIONS SUBJECT TO CHANGE WITHOUT NOTICE
DIMENSIONS ARE FOR REFERENCE ONLY

	VALUE
INDEX OF REFRACTION	1.3
POWER CONSUMPTION (W)	0 - 0.70
WAVELENGTH RANGE (nm)	420 - 950
TUNING RANGE (DIOPTERS)	-2 TO +3
SETTLING TIME (ms)	25 (TYP @ 30°C)



ALL DIMS IN

mm



Edmund Optics®

TITLE

-2 TO +3 DIOPTER, C-MOUNT TO C-MOUNT
FOCUS TUNABLE LENS

DWG NO

78518

SHEET
1 OF 1