

NOTES:

- 1. SUBSTRATE: FUSED SILICA
- 2. COATING (APPLY ACROSS COATING APERTURE):  
S1 & S2: VIS 0° (425-675nm)  
R(AVG) ≤0.4% @ 425 - 675nm
- 3. EFFECTIVE FOCAL LENGTH: 18.80mm
- 4. DIVERGENCE ANGLE: ±0.5°
- 5. WAVELENGTH RANGE (nm): 250 - 700
- 6. ROHS: COMPLIANT

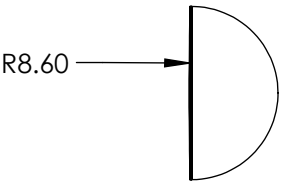

DETAIL A

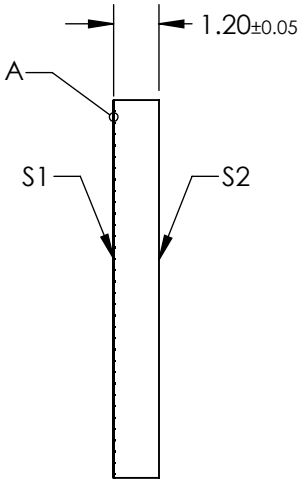
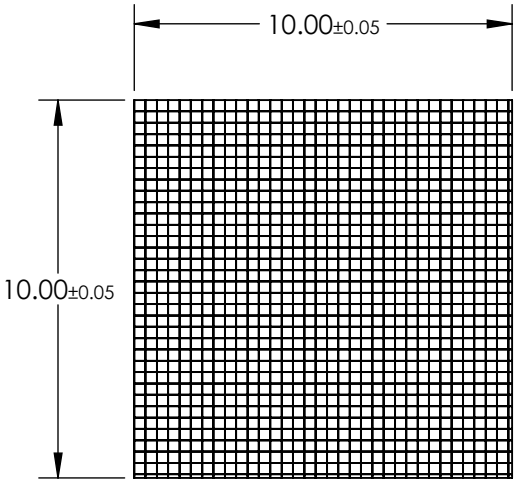

SPECIFICATIONS SUBJECT TO CHANGE WITHOUT NOTICE  
DIMENSIONS ARE FOR REFERENCE ONLY

**FOR INFORMATION ONLY:  
DO NOT MANUFACTURE  
PARTS TO THIS DRAWING**

**Edmund Optics®**

THIRD ANGLE PROJECTION		TITLE		Microlens Array 10 x 10mm, 300µm Pitch, 0.5° Divergence, UV-0° Coated	
ALL DIMS IN	mm	DWG NO	72243	SHEET 1 OF 1	