

NOTES:

1. SUBSTRATE:  
FUSED SILICA

2. COATING (APPLY ACROSS CLEAR APERTURE)  
S1 & S2: NONE

3. FINE GRIND SURFACE

4. POWER, IRREGULARITY, AND SURFACE QUALITY  
SPECIFICATIONS APPLY ACROSS CLEAR APERTURE

5. ROHS COMPLIANT

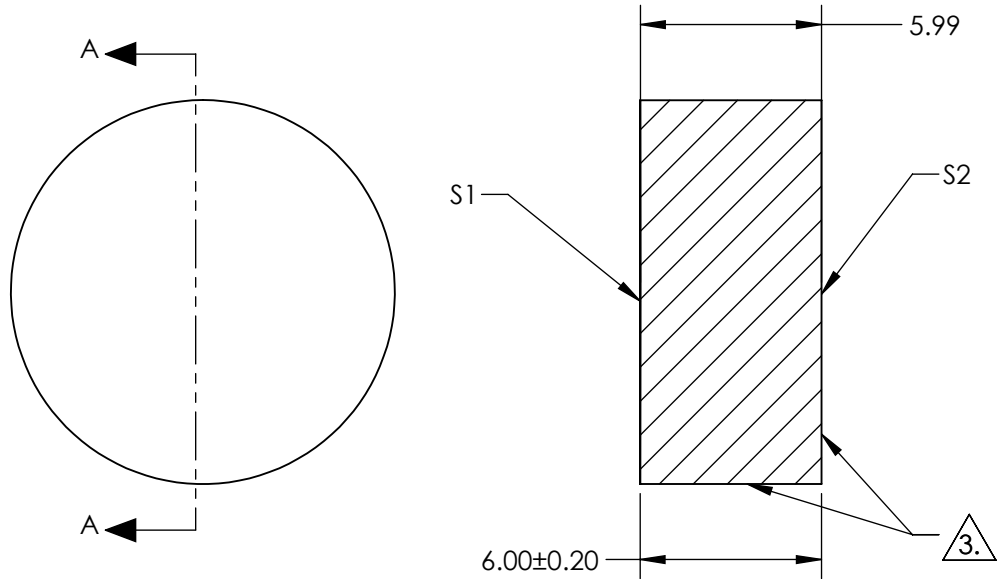

**FOR INFORMATION ONLY:  
DO NOT MANUFACTURE  
PARTS TO THIS DRAWING**

SPECIFICATIONS SUBJECT TO CHANGE WITHOUT NOTICE  
DIMENSIONS ARE FOR REFERENCE ONLY

	S1	S2
SHAPE	CONCAVE	PLANO
RADIUS	3000	INFINITY
SURFACE QUALITY	20-10	N/A
CLEAR APERTURE	Ø 11.43	N/A
IRREGULARITY AT 632.8nm	λ/10	N/A
BEVEL	PROTECTED AS NEEDED	PROTECTED AS NEEDED

THIRD ANGLE PROJECTION	
ALL DIMS IN	mm

**EO**® **Edmund Optics®**

TITLE	12.7mm Dia. x 3000mm ROC, Uncoated, Concave Laser Mirror		
DWG NO	27599	SHEET 21 OF 21	