

NOTES:

1. COATING (APPLY ACROSS CLEAR APERTURE)

LASER V-COAT

R(obs) 0.25% @ 532 nm

2. RoHS COMPLIANT

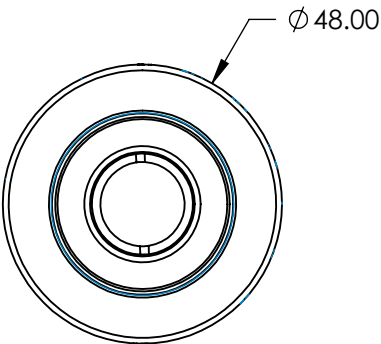
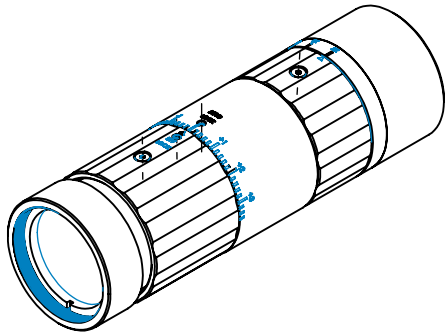
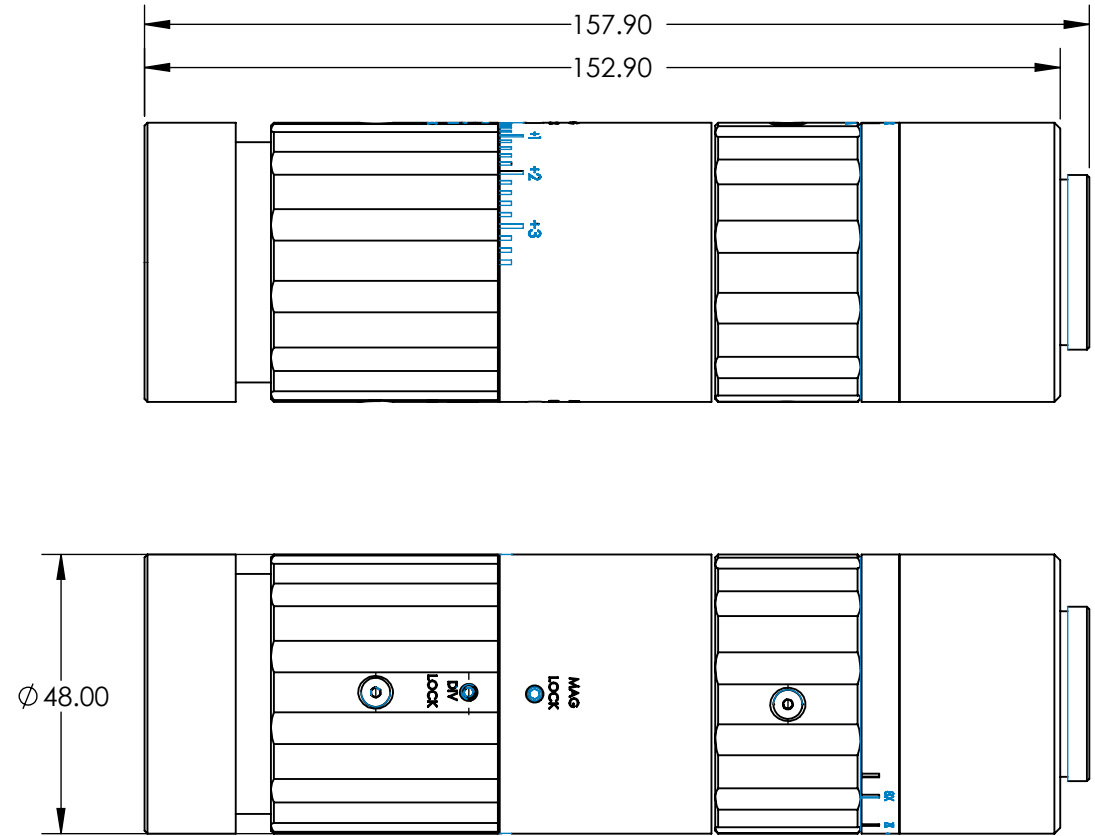

**FOR INFORMATION ONLY:
DO NOT MANUFACTURE
PARTS TO THIS DRAWING**

SPECIFICATIONS SUBJECT TO CHANGE WITHOUT NOTICE
DIMENSIONS ARE FOR REFERENCE ONLY

DAMAGE THRESHOLD (PULSED)	10 J/cm2 @ 532nm, 20ns, 20Hz
DESIGN WAVELENGTH DWL (nm)	532
TRANSMISSION	>98 @ DWL
TRANSMITTED WAVEFRONT, P-V	< $\lambda/4$ for Input Beam 3.5mm (2X - 5.5X), < $\lambda/4$ for Input Beam 3mm (<6.5X) < $\lambda/4$ for Input Beam 2mm (<8X)

THIRD ANGLE PROJECTION	
ALL DIMS IN	mm

EO® Edmund Optics®

TITLE	532nm 2X -8X Gemma® Variable Beam Expander
DWG NO	15544
SHEET	1 OF 1