

NOTES:

- 1. SUBSTRATE:  
Fused Silica
- 2. COATING (APPLY ACROSS COATING APERTURE):  
S1 & S2: R(ABS) ≤1.0% @ 350 - 450nm  
R(AVG) ≤1.5% @ 250 - 700nm
- 3. EFFECTIVE FOCAL LENGTH: 8.7mm
- 4. DIVERGENCE ANGLE: ±1 °
- 5. WAVELENGTH RANGE (nm): 250 - 700
- 6. ROHS: COMPLIANT

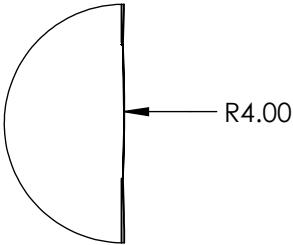

DETAIL A

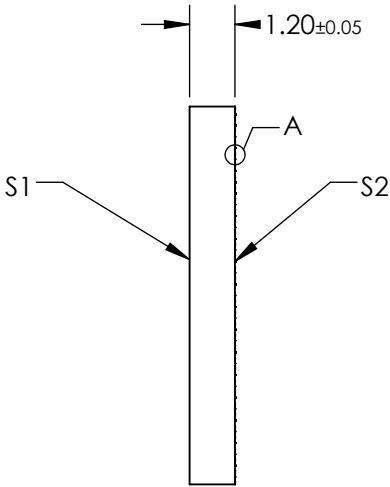
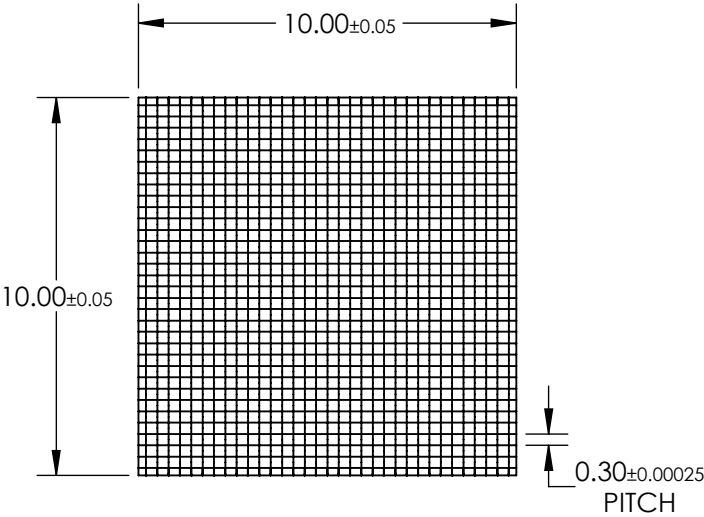

SPECIFICATIONS SUBJECT TO CHANGE WITHOUT NOTICE  
DIMENSIONS ARE FOR REFERENCE ONLY

**FOR INFORMATION ONLY:  
DO NOT MANUFACTURE  
PARTS TO THIS DRAWING**

**Edmund Optics®**

THIRD ANGLE PROJECTION		TITLE	Microlens Array 10 x 10mm, 300µm Pitch, 1° Divergence, UV-VIS Coated	
ALL DIMS IN	mm	DWG NO	21148	SHEET 1 OF 1