

NOTES:

- 1. SUBSTRATE: UV GRADE FUSED SILICA
- 2. COATING (APPLY ACROSS CLEAR APERTURE)  
S1 & S2: R(ABS) < 0.25% @ 532nm  
R(ABS) < 0.25% @ 1064nm  
R(AVG) < 1.0% @ 500 - 1100nm
- 3. SURFACE S2 TO BE PARALLEL WITH S1 TO WITHIN <5 ARCSEC

 FINE GRIND SURFACE

- 5. RoHS COMPLIANT

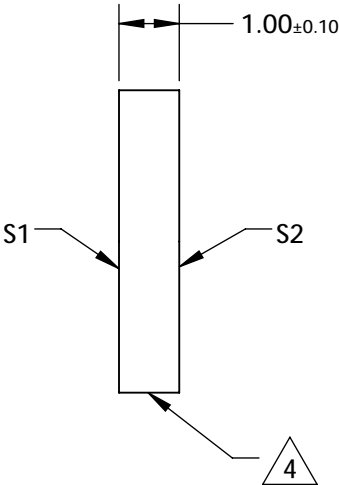
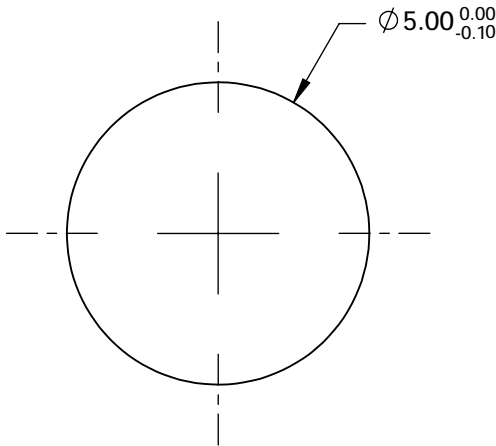
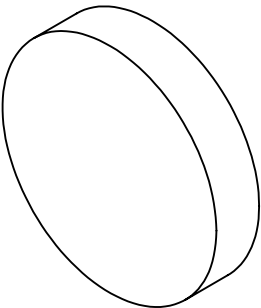

**FOR INFORMATION ONLY:  
DO NOT MANUFACTURE  
PARTS TO THIS DRAWING**

SPECIFICATIONS SUBJECT TO CHANGE WITHOUT NOTICE  
DIMENSIONS ARE FOR REFERENCE ONLY

	S1	S2
SHAPE	PLANO	PLANO
SURFACE QUALITY	20-10	20-10
CLEAR APERTURE	Ø4.00	Ø4.00
BEVEL	PROTECTIVE AS NEEDED	PROTECTIVE AS NEEDED



ALL DIMS IN mm

 **Edmund Optics®**

TITLE 5mm DIA., 1mm THICK, YAG-BBAR COATED,  
λ/10 FUSED SILICA WINDOW

DWG NO 13347

SHEET  
1 OF 1