

NOTES:

- 1. MATERIAL:
HOUSING: BLACK ANODIZED ALUMINUM
LENS: BLACK DIAMOND BD-6
- 2. COATING (APPLY ACROSS COATING APERTURE)
BBAR (8000 - 12000nm)
R(AVG) < 0.75% @ 8000 - 12000nm

3. CLEAR APERTURE: 3.50mm

4. RoHS: COMPLIANT

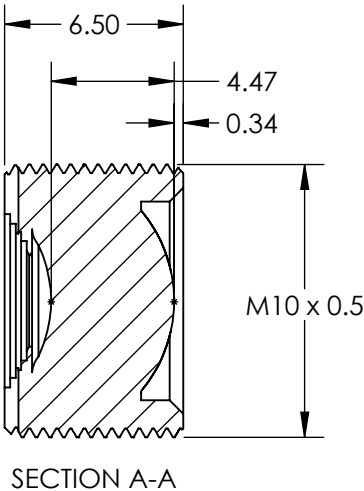
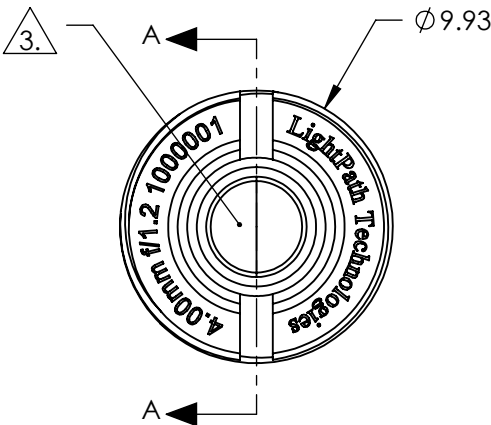
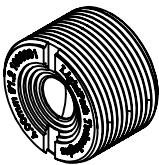

SPECIFICATIONS SUBJECT TO CHANGE WITHOUT NOTICE
DIMENSIONS ARE FOR REFERENCE ONLY

**FOR INFORMATION ONLY:
DO NOT MANUFACTURE
PARTS TO THIS DRAWING**

EO[®] Edmund Optics[®]

| | | | | |
|--|----|--------|--|--------------|
| THIRD ANGLE PROJECTION  | | TITLE | LIGHTPATH 7100410 4mm FL, f/1.2, THERMAL IMAGING LENS ASSEMBLY | |
| ALL DIMS IN | mm | DWG NO | 15685 | SHEET 1 OF 1 |