

NOTES:

1. MATERIAL: BLACK ANODIZED ALUMINUM
2. RoHS: COMPLIANT

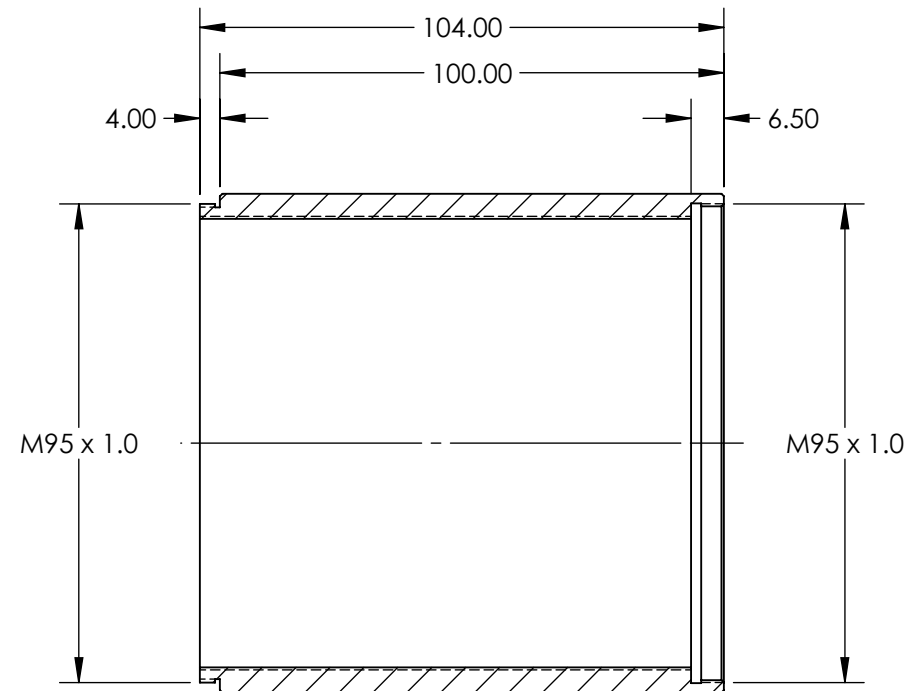
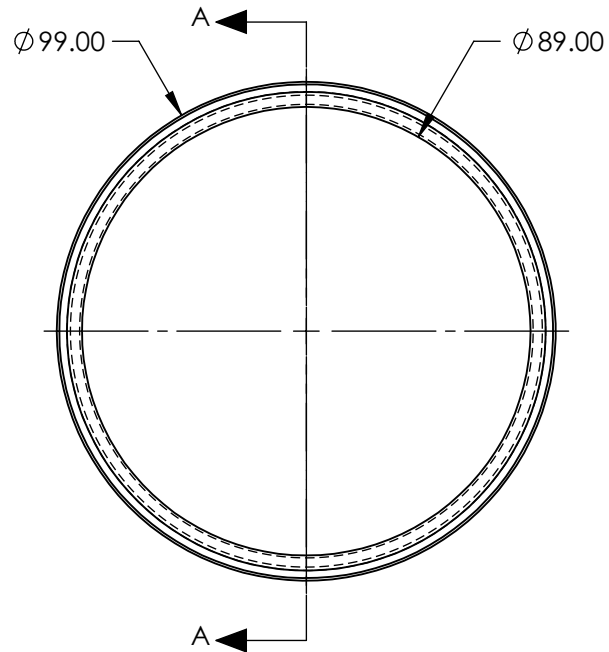

SECTION A-A

SPECIFICATIONS SUBJECT TO CHANGE WITHOUT NOTICE
DIMENSIONS ARE FOR REFERENCE ONLY

**FOR INFORMATION ONLY:
DO NOT MANUFACTURE
PARTS TO THIS DRAWING**

Edmund Optics®

THIRD ANGLE PROJECTION	TITLE	100mm M95 x 1mm EXTENSION TUBE	
ALL DIMS IN	mm	DWG NO	SHEET 1 OF 1
		13971	