

- NOTES:
1. SUBSTRATE: LOW DISPERSION POLYMER
 2. COATING (APPLIES ACROSS CLEAR APERTURE):
BBAR (400-700nm)

DAMAGE THRESHOLD, CW:
10 kW/cm² @ 1064nm
 3. TRANSMITTED WAVEFRONT ERROR:
 $\lambda/4$ @ 525nm
 4. RoHS: COMPLIANT

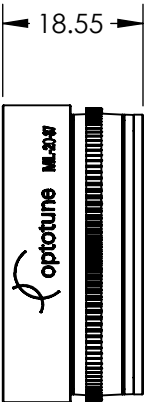
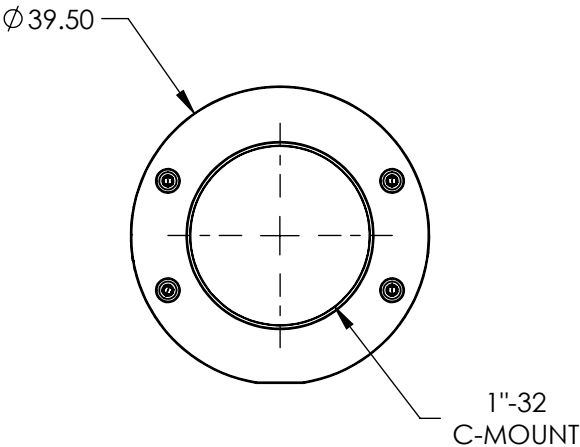
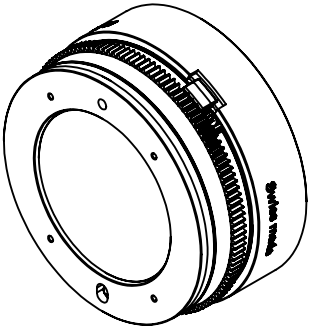

**FOR INFORMATION ONLY:
DO NOT MANUFACTURE
PARTS TO THIS DRAWING**

SPECIFICATIONS SUBJECT TO CHANGE WITHOUT NOTICE
DIMENSIONS ARE FOR REFERENCE ONLY

	VALUE
INDEX OF REFRACTION	1.38
FOCUS RANGE	-18 TO +18 DIOPTER
ABBE NUMBER	65
LIFE CYCLES	>100,000
CLEAR APERTURE	Ø20.00



ALL DIMS IN

mm

EO® Edmund Optics®

TITLE

-18 TO +18 DIOPTERS, VIS COATED, MANUALLY
FOCUS-TUNABLE LENS

DWG NO

12329

SHEET
1 OF 1