

NOTES:

- 1. SUBSTRATE MATERIAL:  
BOROFLOAT®
- 2. COATING (APPLY ACROSS CLEAR APERTURE)  
  
S1: NONE  
S2: NONE
- 3. POWER, IRREGULARITY, SURFACE QUALITY, AND COATING  
SPECIFICATIONS APPLY ACROSS CLEAR APERTURE
- 4. FINE GROUND SURFACE
- 5. ROHS COMPLIANT

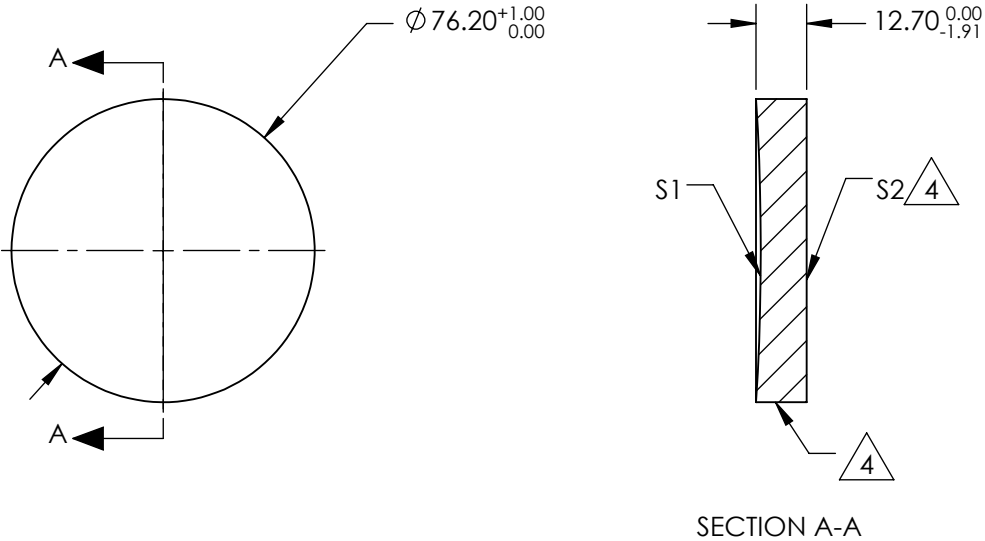

**FOR INFORMATION ONLY:  
DO NOT MANUFACTURE  
PARTS TO THIS DRAWING**

SPECIFICATIONS SUBJECT TO CHANGE WITHOUT NOTICE  
DIMENSIONS ARE FOR REFERENCE ONLY

REV. A	S1	S2				
SHAPE	CONCAVE	PLANO				
EFFECTIVE FOCAL LENGTH	304.8mm	N/A				
FOCAL LENGTH TOLERANCE	±2%	N/A				
APERTURE	f/4	N/A				
SURFACE QUALITY	60-40	60-40				
SURFACE FLATNESS	λ/4	λ/4				
BEVEL	PROTECTIVE AS NEEDED	PROTECTIVE AS NEEDED				

THIRD ANGLE PROJECTION		TITLE		DWG NO		SHEET 1 OF 1	
ALL DIMS IN		mm		49614			

Edmund Optics®

Ø3in, 12in FL ENHANCED ALIUMINUM,  
SPHERICAL MIRRORS