

NOTES:

1. SUBSTRATE MATERIAL:
BOROFLOAT®
2. COATING (APPLY ACROSS CLEAR APERTURE)

S1: NONE
S2: NONE
3. POWER, IRREGULARITY, SURFACE QUALITY, AND COATING
SPECIFICATIONS APPLY ACROSS CLEAR APERTURE
4.

FINE GROUND SURFACE
5. ROHS COMPLIANT

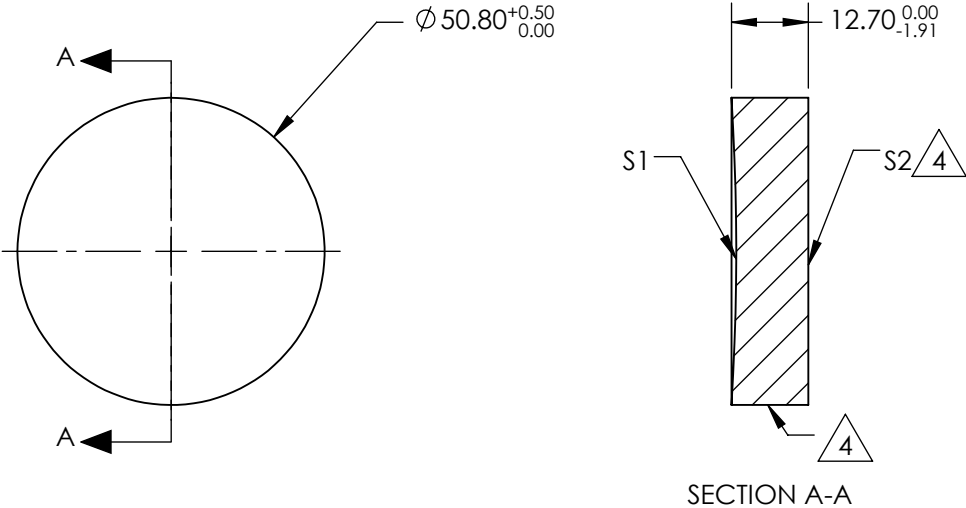

**FOR INFORMATION ONLY:
DO NOT MANUFACTURE
PARTS TO THIS DRAWING**

SPECIFICATIONS SUBJECT TO CHANGE WITHOUT NOTICE
DIMENSIONS ARE FOR REFERENCE ONLY

REV. A	S1	S2				
SHAPE	CONCAVE	PLANO				
EFFECTIVE FOCAL LENGTH	203.2mm	N/A				
FOCAL LENGTH TOLERANCE	±2%	N/A				
APERTURE	f/4	N/A				
SURFACE QUALITY	60-40	60-40				
SURFACE FLATNESS	λ/4	λ/4				
BEVEL	PROTECTIVE AS NEEDED	PROTECTIVE AS NEEDED				

THIRD ANGLE PROJECTION		TITLE		2" Dia, 8" FL Enhanced Alum., Spherical Mirror	
ALL DIMS IN	mm	DWG NO	49613	SHEET 1 OF 1	