

NOTES:

- 1. SUBSTRATE
FUSED SILICA
- 2. SURFACE S2 TO BE PARALLEL WITH S1 WITHIN < 3 ARCMIN
- 3. COATING (APPLY ACROSS CLEAR APERTURE)
S1: DIELECTRIC
R(ABS) >99.5% @ 532 & 1064nm @ 45° AOI

DAMAGE THRESHOLD,
PULSED: 20 J/cm² @ 20ns

S2: NONE

4. FINE GROUND SURFACE

- 5. POWER, IRREGULARITY, SURFACE QUALITY, AND COATING SPECIFICATIONS APPLY ACROSS CLEAR APERTURE
- 6. RoHS COMPLIANT

FOR INFORMATION ONLY:
DO NOT MANUFACTURE
PARTS TO THIS DRAWING

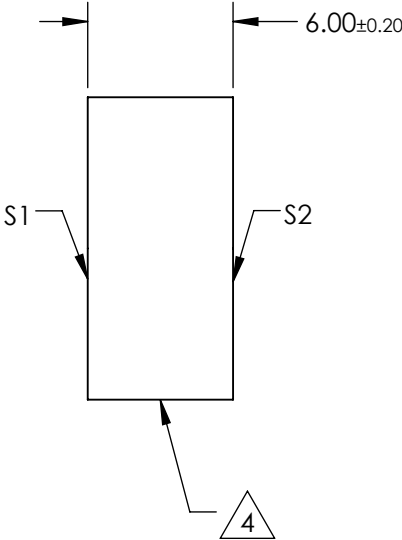
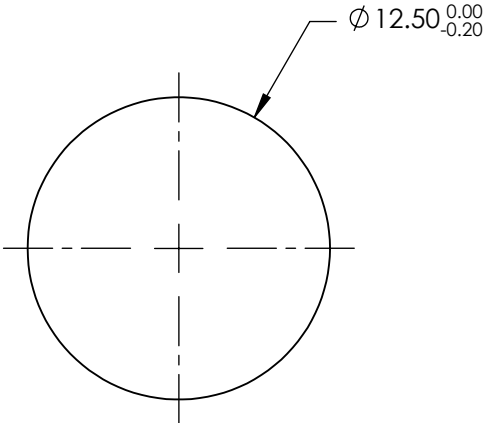

SPECIFICATIONS SUBJECT TO CHANGE WITHOUT NOTICE
DIMENSIONS ARE FOR REFERENCE ONLY

	S1	S2	<div><div><div><div><div></div></div></div><div><div></div></div></div><div>Edmund Optics®</div></div>			
SHAPE	PLANO	PLANO				
SURFACE FLATNESS	λ/10	N/A	<div>THIRD ANGLE PROJECTION</div>	TITLE	12.5mm Dia. x 6mm 532/1064nm, Dual Band Laser Mirror	
SURFACE QUALITY	10-5	FINE GROUND				
CLEAR APERTURE	Ø11.25	N/A				
BEVEL	PROTECTIVE AS NEEDED	PROTECTIVE AS NEEDED				
			ALL DIMS IN	mm	DWG NO	47976
						SHEET 1 OF 1