

TECHSPEC® 6mm, f/1.8 Cw Series Fixed Focal Length Lens

#15-620



6mm Focal Length

해당 제품은 [TECHSPEC® C Series Fixed Focal Length Lens](#)의 Waterproof 버전입니다. 해당 제품은 IEC 방수방진 규정 중 IPX7 및 IPX9K 등급을 준수하도록 설계되었으며 최대 1m 깊이의 물에 30분 동안 잠겨도 견딜 수 있고 가까운 거리에서 물을 고압·고온으로 제품에 분사해도 작동합니다(단, 3.5mm 및 4.5mm 제품은 IPX7 등급만 준수합니다). 발수 코팅 처리를 한 윈도우가 장착된 제품이라 렌즈 표면에 물방울이 맺히지 않습니다. 또한, 하우징에 습기가 차는 것을 방지하기 위해 여러 개의 O링으로 씰링 처리를 했습니다. 해상도는 최대 500만 화소이며 최대 2/3" 센서 포맷과 호환되는 제품으로 식품, 의약품, 자동차, 보안 등의 어플리케이션에 적합합니다. 또한, 비전 시스템즈 디자인이 주최하는 2021 이노베이터 어워즈에서 동상을 수상했습니다.

General

Note:	C-Mount compatible with O-ring 25mm ID x 2mm
Type:	Fixed Focal Length Lens

Physical & Mechanical Properties

Iris Option:	Fixed
Length (mm):	51.40
Maximum Diameter (mm):	46.00
Maximum Rear Protrusion (mm):	1.2

Optical Properties

Horizontal Field of View, 1/2" Sensor:	55.8°
Horizontal Field of View, 1/3" Sensor:	42.7°
Maximum Image Circle (mm):	9.00
Numerical Aperture NA, Object Side:	0.0180
Number of Elements (Groups):	10 (9)
Horizontal Field of View, 1/1.8" Sensor:	62.1°
Horizontal Field of View, 1/2.5" Sensor:	50.7°
Focal Length FL (mm):	6.00
Primary Magnification PMAG:	-0.064
Working Distance (mm):	75 - ∞
Aperture (f/#):	f/1.8
Coating Specification:	425 - 675nm BBAR
Entrance Pupil Position (mm):	21.52
Object Space Principal Plane (mm):	-33.64
Image Space Principal Plane (mm):	22.43
Field of View at Max Sensor Format:	Horizontal: 62.1° Vertical: 47.7° Diagonal: 75.0°
Maximum Distortion (%):	6.868
Exit Pupil Position (mm):	-25.51
Lens Wavelength Range:	VIS

Sensor

Maximum Sensor Format:	1/1.8"
------------------------	--------

Threading & Mounting

Filter Thread:	M30.5 x 0.50 (Female)
Mount:	C-Mount

Environmental & Durability Factors

Environmental Rating:	IPX7 and IPX9K
-----------------------	----------------

Storage Temperature (°C):

-20 to +60 For questions regarding operating temperature please
contact our support team

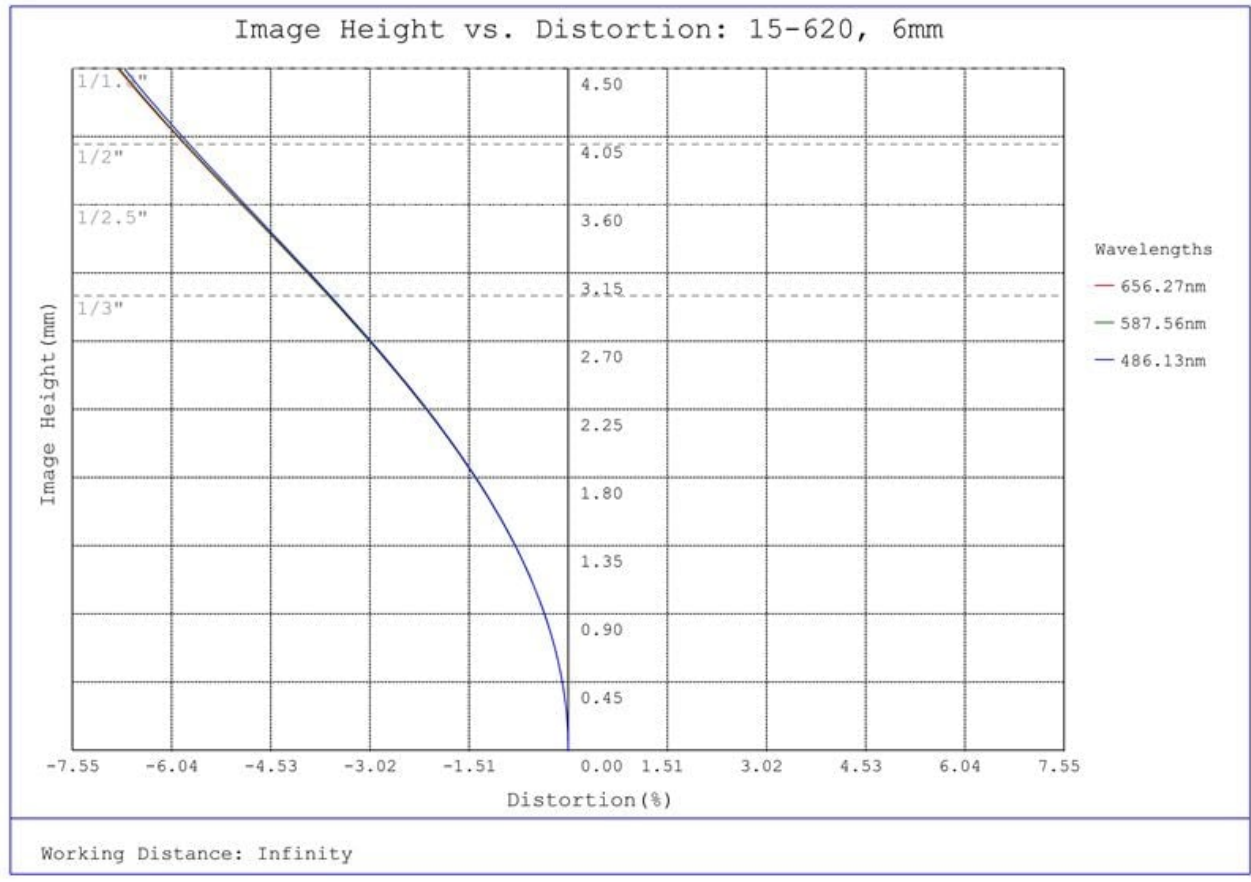

#15-620, 6mm, f/1.8 Cw Series Fixed Focal Length Lens, Distortion Plot

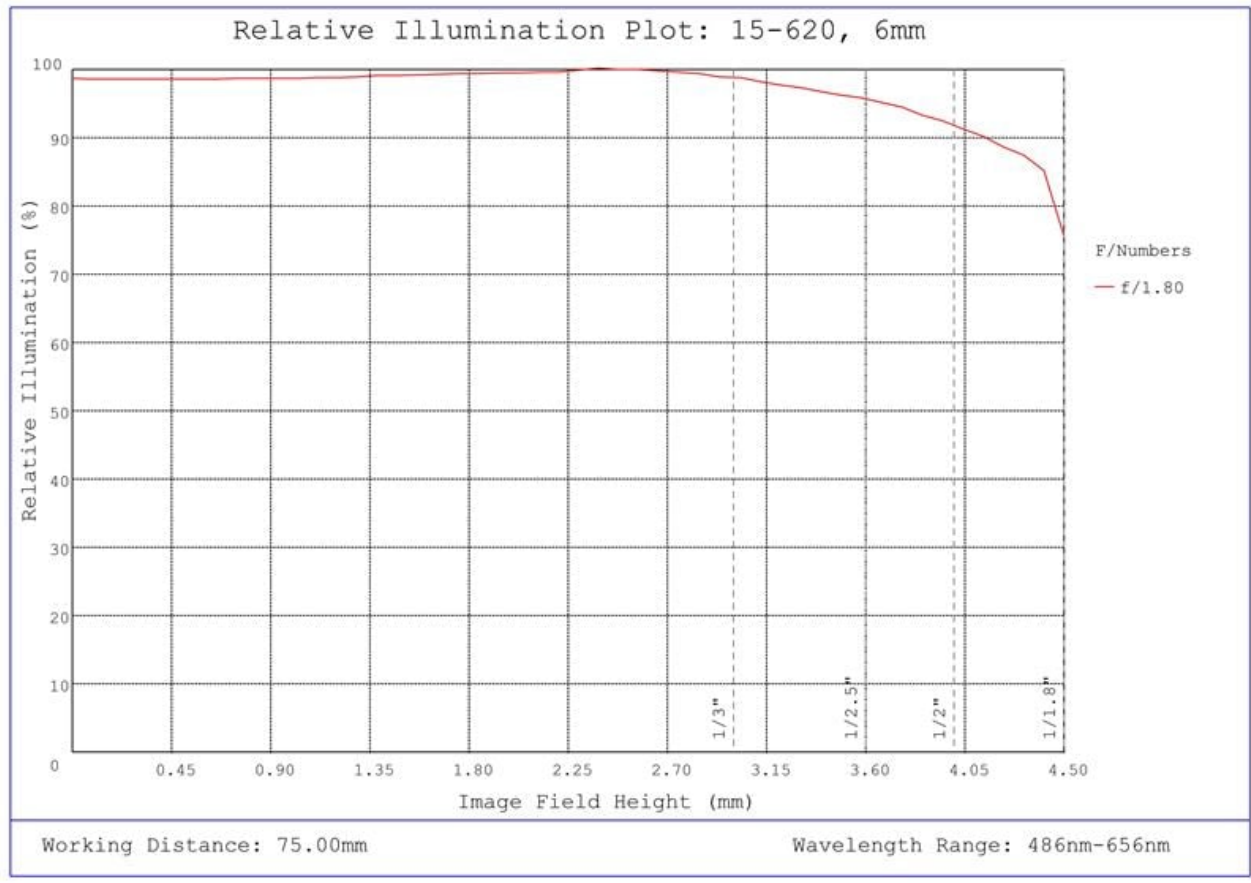

#15-620, 6mm, f/1.8 Cw Series Fixed Focal Length Lens, Relative Illumination Plot

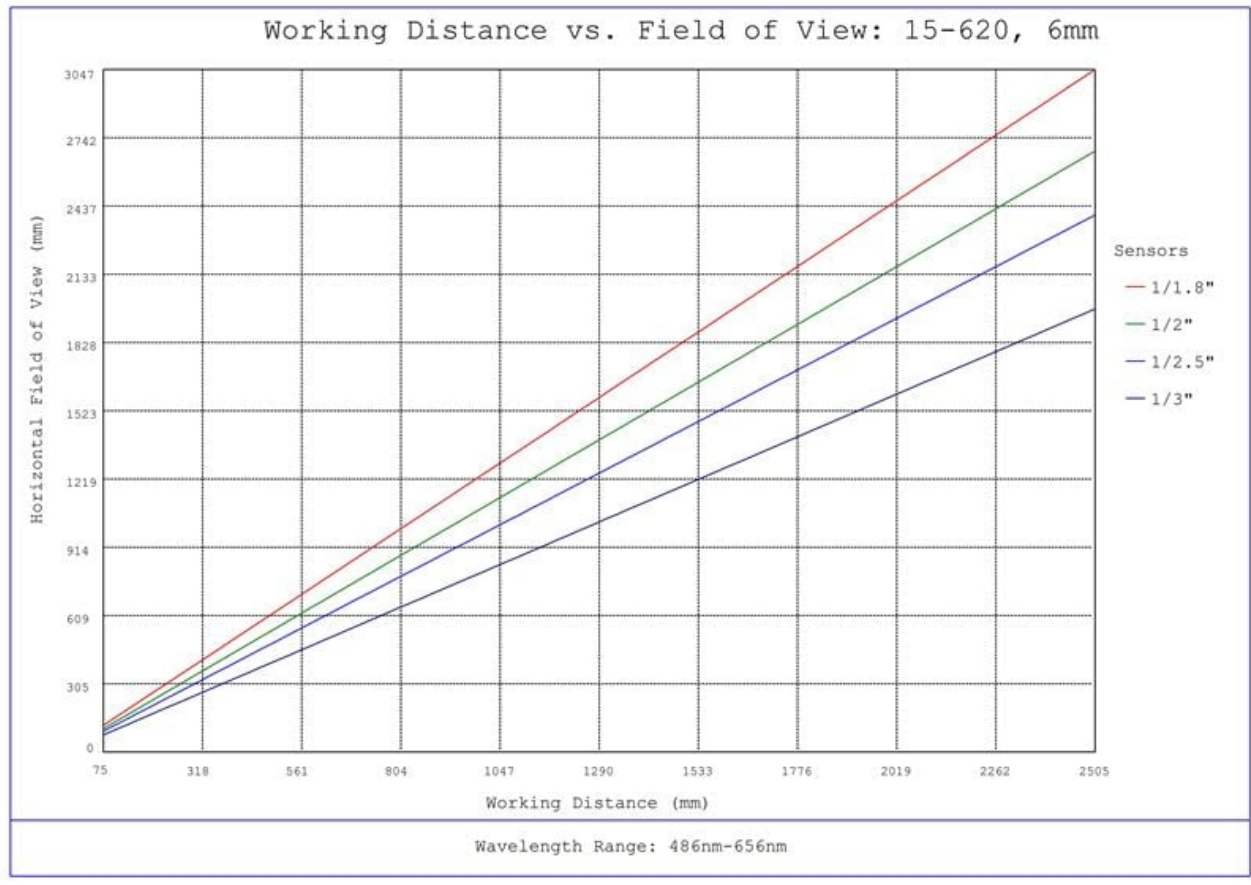

#15-620, 6mm, f/1.8 Cw Series Fixed Focal Length Lens, Working Distance versus Field of View Plot

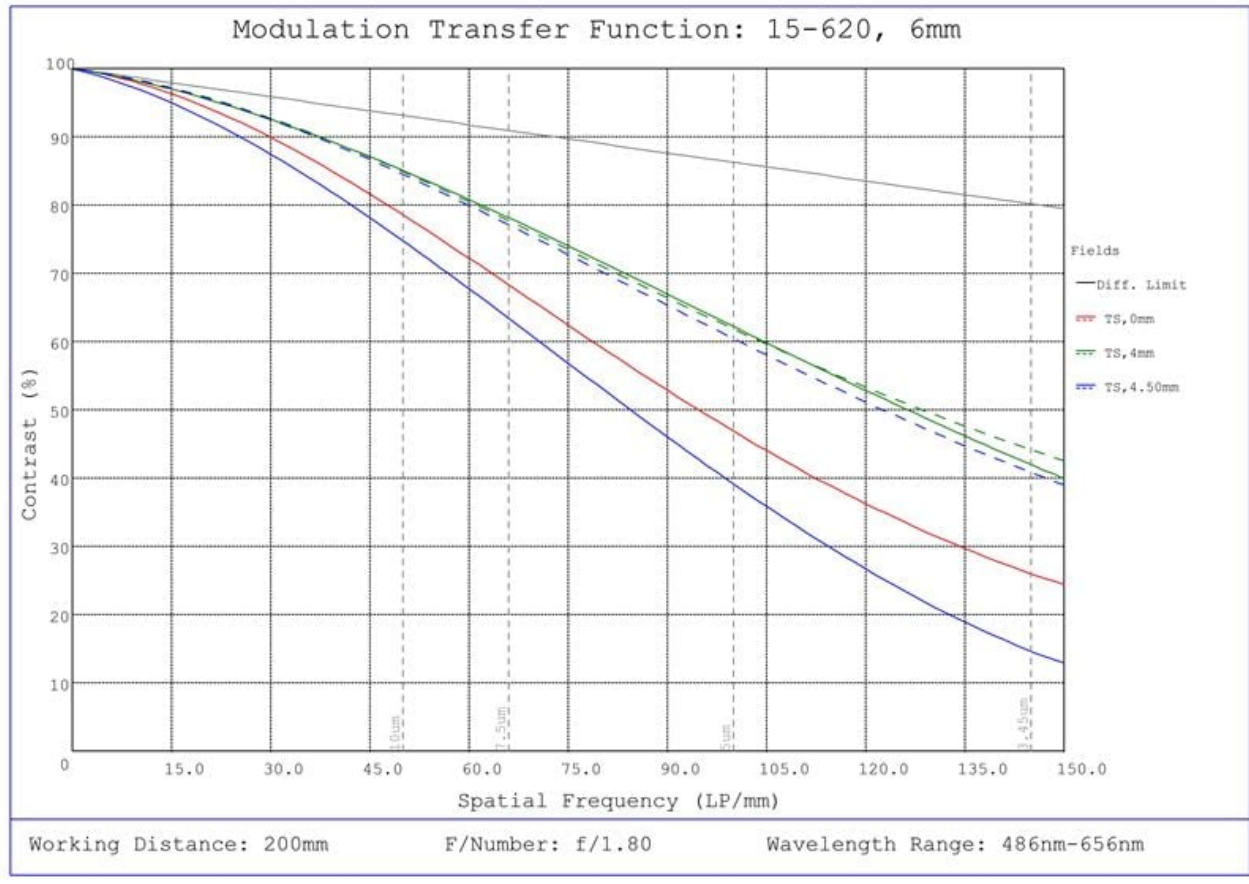

#15-620, 6mm, f/1.8 Cw Series Fixed Focal Length Lens, Modulated Transfer Function (MTF) Plot, 200mm Working Distance, f1.8



#15-620, 6mm, f/1.8 Cw Series Fixed Focal Length Lens, Depth of Field Plot, 200mm Working Distance, f1.8

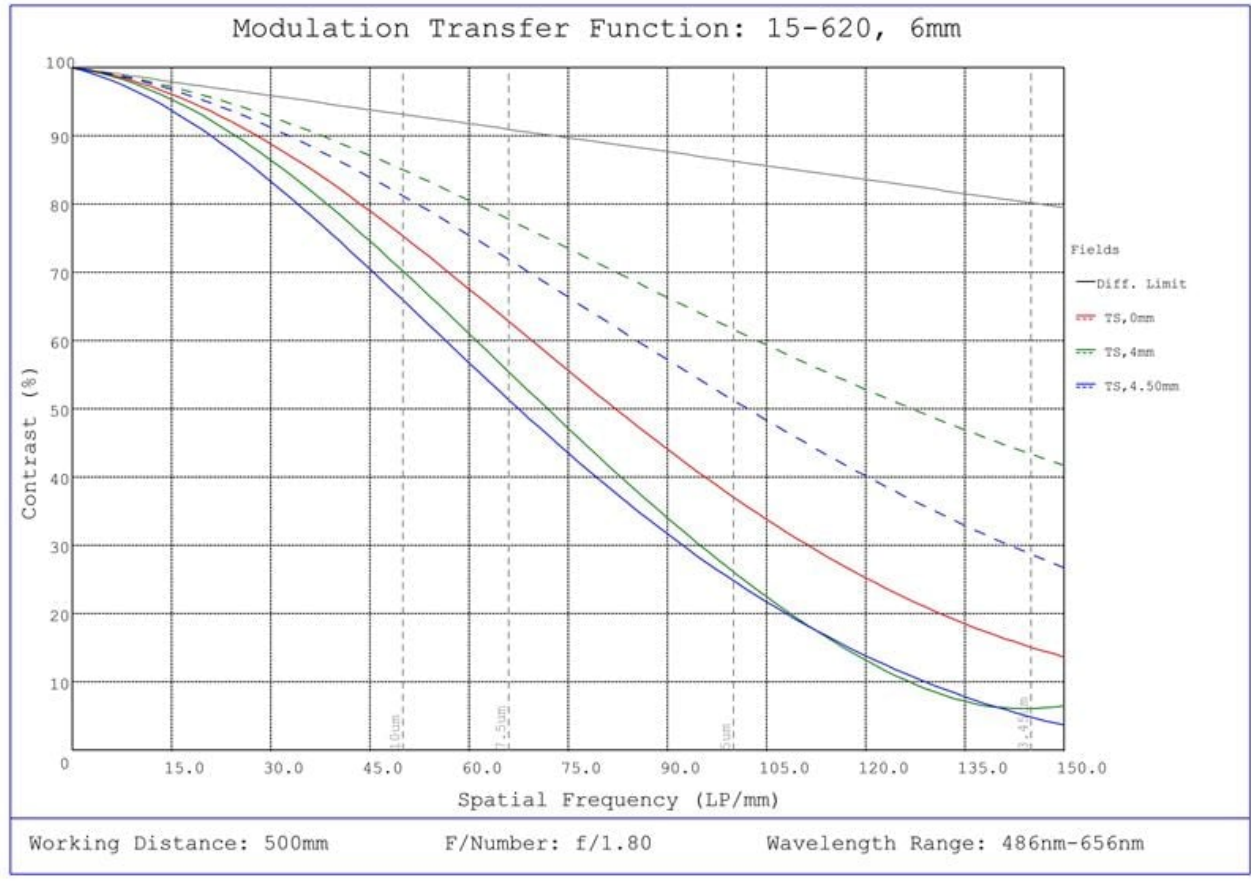

#15-620, 6mm, f/1.8 Cw Series Fixed Focal Length Lens, Modulated Transfer Function (MTF) Plot, 500mm Working Distance, f1.8

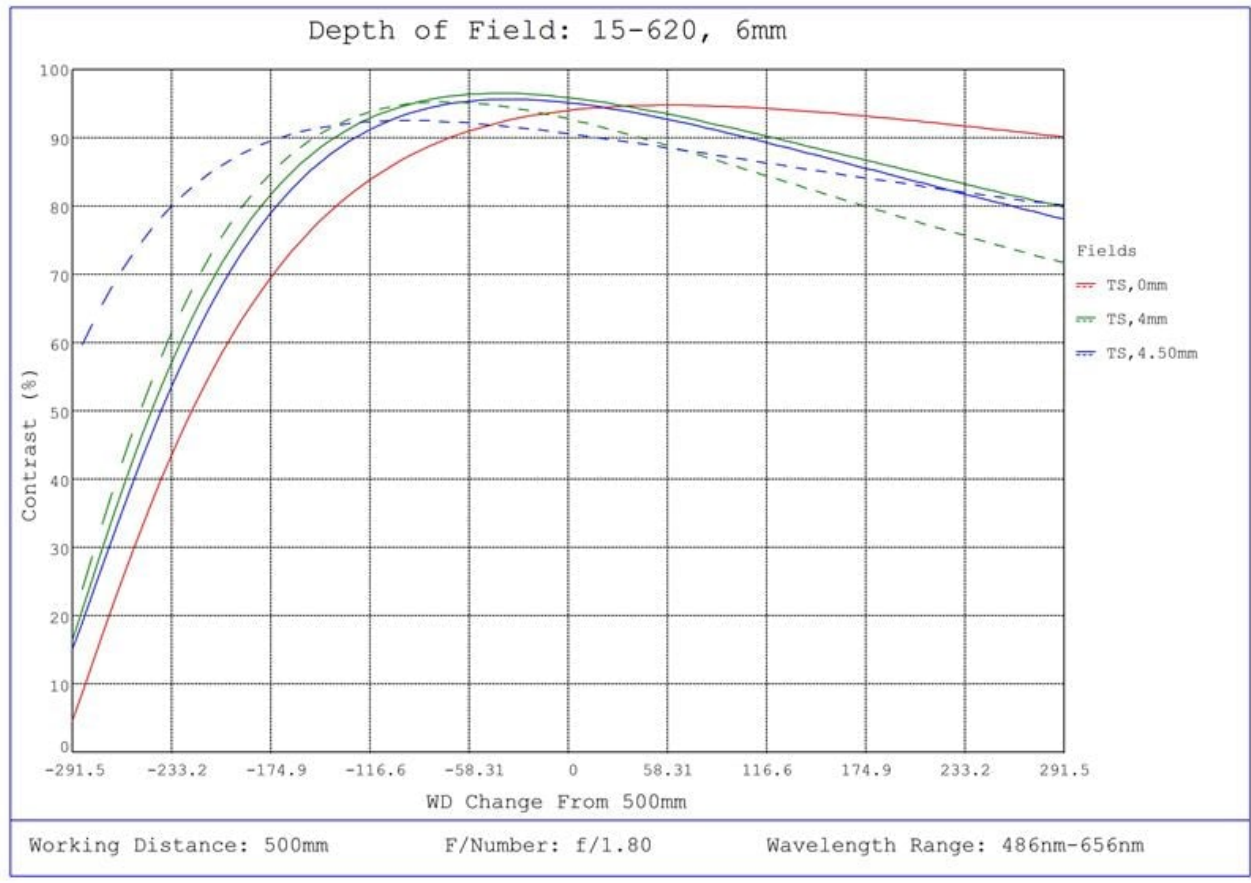

#15-620, 6mm, f/1.8 Cw Series Fixed Focal Length Lens, Depth of Field Plot, 500mm Working Distance, f1.8



June 21, 2025

To Whom It May Concern,

This document certifies that the product stated below has been reviewed as requested by Edmund Optics:

재고 번호	제품설명
15-620	6mm, f/1.8 Cw Series Fixed Focal Length Lens

This item is EU RoHS (2011/65/EU) compliant without the use of exemptions.

This certification means that:

- EO's suppliers have confirmed the material composition of this product.
- EO has implemented rigorous procedures to document this compliance.
- The information provided may, or may not, be based upon actual test data, or on information from our Vendors, Raw Material Suppliers or Subcontractors.



Jay Budd, Director of Corporate Compliance
June 21, 2025

Edmund Optics Inc. - 101 E Gloucester Pike, Barrington, NJ 08007 | 1-800-363-1992 | Compliance@edmundoptics.com

June 21, 2025

재고 번호	제품설명
15-620	6mm, f/1.8 Cw Series Fixed Focal Length Lens

Edmund Optics certifies that all articles included in this shipment are in compliance with the terms and conditions of this order. The company also certifies that the articles included in this shipment are in accordance to all agreed upon specifications and quality assurance provisions. Please call 1-800-363-1992 should any questions arise from this shipment.



Jeff Harvey- EVP of Operations

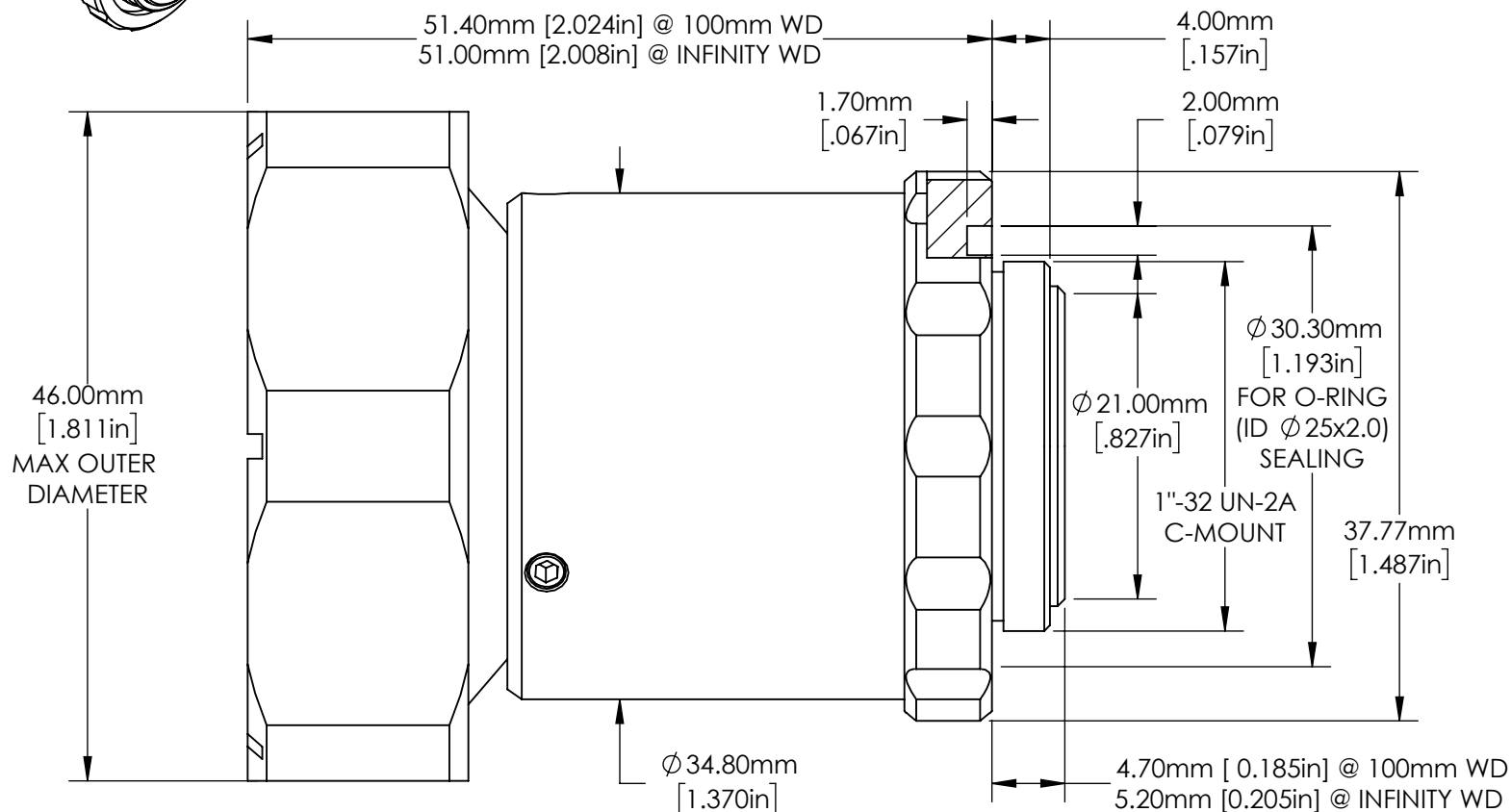
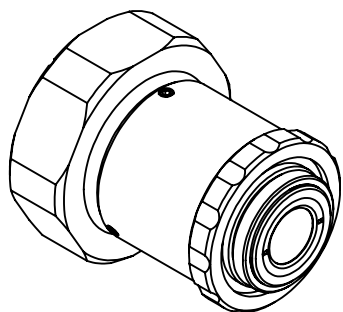

**FOR INFORMATION ONLY:
DO NOT MANUFACTURE
PARTS TO THIS DRAWING**

SPECIFICATIONS SUBJECT TO CHANGE WITHOUT NOTICE
DIMENSIONS ARE FOR REFERENCE ONLY

Edmund Optics®

THIRD ANGLE PROJECTION		TITLE	6mm Cw Series Lens, f1.8	
			DWG NO	15620
ALL DIMS IN	mm			SHEET 1 OF 1