

TECHSPEC® Compact Kinematic Solid Plate Mount, 2-Screws

#34-722



Compact Kinematic Mount, 2-Screws, #34-722

당사의 TECHSPEC® Compact Kinematics는 더 큰 움직임의 kinematic 성능을 유지하면서 공간 제약이 있는 용도에
 서의 통합이 가능하도록 설계되었습니다. 이 kinematics는 OEM 용도 통합을 위해 작은 홈이 파인 조절 나사를 특징
 으로 합니다. TECHSPEC® Compact Kinematic Mounts는 고정 나사의 활용과 점착성 오픈 보호를 위한 두 가지
 front plate 모델을 가지고 있습니다. 품질과 안정성 보장 위해 stainless steel insert도 사용됩니다. 이러한 kinematic
 mounts는 당사의 [TECHSPEC® Laser Mirrors](#)와 호환 가능하며, laser machining, cinema, life science 용도와의 신
 뢰성 있는 통합에 이상적인 제품입니다.

General

Type:	Adjustable - Tip-Tilt
Type of Optics:	Square or Rectangular
Number of Adjustment Screws:	2
Plate Dimensions (mm):	22.5 x 22.5

Physical & Mechanical Properties

Clear Aperture CA (mm):	N/A
Thickness (mm):	19.60
Travel (mm):	No Z-Axis Translation
Construction:	Aluminum Plates, Stainless Steel Screws, and Brass Thread Bushings
Fine Tilt Angle (°):	±5
Fine Tip Angle (°):	±5
Adjustment Screw Pitch (mm):	0.2
Min. Thickness of Compatible Optics (mm):	N/A
Centerline Height (mm):	15.0
Thickness of Front Plate to Back Plate (mm):	19.6
Pointing Stability (μrad):	1.3

Threading & Mounting

Size of Compatible Optics (mm):	3.00 - 25.40
Compatible Post:	M4 x 0.7



June 20, 2025

To Whom It May Concern,

This document certifies that the product stated below has been reviewed as requested by Edmund Optics:

재고 번호	제품설명
34-722	Compact Kinematic Solid Plate Mount, 2-Screws

This item is EU RoHS (2015/863/EU) compliant without the use of exemptions.

This certification means that:

- EO's suppliers have confirmed the material composition of this product.
- EO has implemented rigorous procedures to document this compliance.
- The information provided may, or may not, be based upon actual test data, or on information from our Vendors, Raw Material Suppliers or Subcontractors.



Jay Budd, Director of Corporate Compliance
June 20, 2025

Edmund Optics Inc. - 101 E Gloucester Pike, Barrington, NJ 08007 | 1-800-363-1992 | Compliance@edmundoptics.com



June 20, 2025

To Whom It May Concern,

This document certifies that the product stated below has been reviewed as requested by Edmund Optics:

재고 번호	제품설명
34-722	Compact Kinematic Solid Plate Mount, 2-Screws

This item does not contain any of the substances listed on the Reach SVHC list as of 10 June 2022 in quantities exceeding 0.1% weight by weight.

Please note the following:

- Entry 11 of Annex V of the REACH regulation EC 1907/2006 as amended by regulation 987/2008, exempts "non-hazardous" glass components from registration.
- Items considered to be packing materials and which do not form part of, or are not required for the operation of, the product, are not considered to be within scope of this declaration.
- EO does not routinely analyze products for substances not purposely added or specified within the design specifications, drawings and assembly procedures.

This certification means that:

- EO's suppliers have confirmed the material composition of this product.
- EO has implemented rigorous procedures to document this compliance.
- The information provided may, or may not, be based upon actual test data, or on information from our Vendors, Raw Material Suppliers or Subcontractors.



Jay Budd, Director of Corporate Compliance
June 20, 2025

Edmund Optics Inc. - 101 E Gloucester Pike, Barrington, NJ 08007 | 1-800-363-1992 | Compliance@edmundoptics.com



June 20, 2025

재고 번호

34-722

제품설명

Compact Kinematic Solid Plate Mount, 2-Screws

Edmund Optics certifies that all articles included in this shipment are in compliance with the terms and conditions of this order. The company also certifies that the articles included in this shipment are in accordance to all agreed upon specifications and quality assurance provisions. Please call 1-800-363-1992 should any questions arise from this shipment.



Jeff Harvey- EVP of Operations

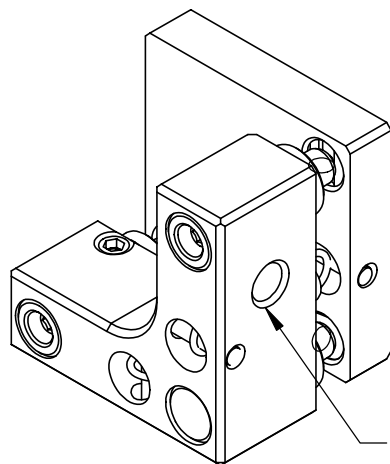

M4 x 0.7 x 7 DEEP FOR
MOUNTING THE KINEMATIC
ASSEMBLY (2X)

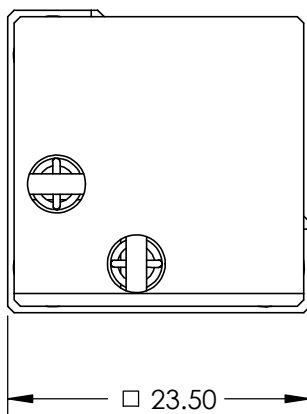
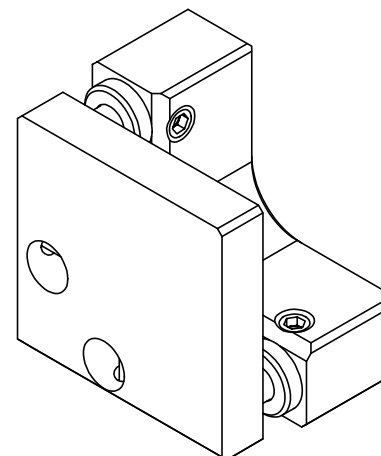

□ 23.50

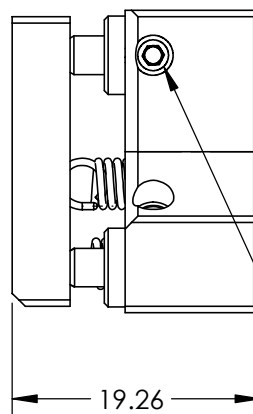

19.26

M3 ADJUSTMENT LOCKING
HEX SOCKET SET SCREWS
(3X)

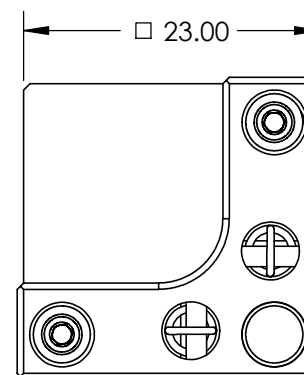

□ 23.00

M3 x 0.2 HEX SOCKET
ADJUSTMENT SCREWS
(3X)

**FOR INFORMATION ONLY:
DO NOT MANUFACTURE
PARTS TO THIS DRAWING**

SPECIFICATIONS SUBJECT TO CHANGE WITHOUT NOTICE
DIMENSIONS ARE FOR REFERENCE ONLY

Edmund Optics®

THIRD ANGLE
PROJECTION

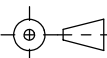

TITLE

SM FLAT KINEMATIC MOUNT 2-SCREW

ALL DIMS IN

mm

DWG NO

34722

SHEET
1 OF 1