

## **TECHSPEC® NIR 750 - 1100nm, 25mm Dia. Longpass Filter Kit (8 Filters)**

#86-480



프로토타입, 연구 및 개발, 그리고 실험실용으로 적합한 TECHSPEC® OD 4.0 High Performance Shortpass and Longpass Filter Kits는 다양한 구성으로 공급됩니다. 각 키트에는 필터별로 개별 구매하는 것에 비해 할인된 가격으로 제공되는 [OD 4.0 Shortpass filters](#) 또는 [OD 4.0 Longpass filters](#)가 포함되어 있습니다. 기본 필터 키트는 50nm 단위로 공급되며, 전체 키트는 25nm 단위로 공급됩니다.

**참고:** 원활하지 못한 공급으로 인하여, 당사의 키트 제품은 나무 박스가 아닌 대체 용기에 포장되어 배송될 수 있습니다. 기타 자세한 사항은 [krsales@edmundoptics.co.kr](mailto:krsales@edmundoptics.co.kr)로 문의 바랍니다.

## General

Filters Included :	Cut-On Wavelength: <a href="#">750nm</a> , <a href="#">800nm</a> , <a href="#">850nm</a> , <a href="#">900nm</a> , <a href="#">950nm</a> , <a href="#">1000nm</a> , <a href="#">1050nm</a> , <a href="#">1100nm</a>
Type:	Longpass Filter
Number of Filters:	8.00

## Physical & Mechanical Properties

Diameter (mm):	25.00
----------------	-------

## Optical Properties

Optical Density OD (Average):	≥4.0
Substrate:	<a href="#">Fused Silica</a> (Corning 7980)
Coating:	Hard Coated
Transmission (%):	≥91
Coating Specification:	Surface 1: Hard Dielectric Sputtered Surface 2: AR Coated
Wavelength Range (nm):	200 - 1650



June 17, 2025

To Whom It May Concern,

This document certifies that the product stated below has been reviewed as requested by Edmund Optics:

재고 번호	제품설명
86-480	NIR 750 - 1100nm, 25mm Dia. Longpass Filter Kit (8 Filters)

The following item(s) are not currently RoHS Compliant

This certification means that:

- EO's suppliers have confirmed the material composition of this product.
- EO has implemented rigorous procedures to document this compliance.
- The information provided may, or may not, be based upon actual test data, or on information from our Vendors, Raw Material Suppliers or Subcontractors.



Jay Budd, Director of Corporate Compliance

June 17, 2025

Edmund Optics Inc. - 101 E Gloucester Pike, Barrington, NJ 08007 | 1-800-363-1992 | [Compliance@edmundoptics.com](mailto:Compliance@edmundoptics.com)

June 17, 2025

재고 번호	제품설명
86-480	NIR 750 - 1100nm, 25mm Dia. Longpass Filter Kit (8 Filters)

Edmund Optics certifies that all articles included in this shipment are in compliance with the terms and conditions of this order. The company also certifies that the articles included in this shipment are in accordance to all agreed upon specifications and quality assurance provisions. Please call 1-800-363-1992 should any questions arise from this shipment.



Jeff Harvey- EVP of Operations



**FOR INFORMATION ONLY:  
DO NOT MANUFACTURE  
PARTS TO THIS DRAWING**

NOTES:

1. SUBSTRATE
2. SURFACE S2 TO BE PARALLEL WITH SURFACE S1 TO WITHIN 5 arcsec
3. COATING (APPLY ACROSS COATING APERTURE)

S1: HARD DIELECTRIC SPUTTERED  
T(avg):  $\geq 91\%$  FROM 765 - 1650nm @ 0° AOI  
T(avg):  $\leq 0.01\%$  FROM 200 - 735nm @ 0° AOI  
T(abs):  $\approx 50\%$  FOR 750 $\pm$ 7.5nm @ 0° AOI

S2: SINGLE LAYER MgF2

**4.** FINE GRIND SURFACE

5. POWER, IRREGULARITY, AND SURFACE QUALITY SPECIFICATIONS  
APPLY ACROSS CLEAR APERTURE
6. TRANSMITTED WAVEFRONT DISTORTION, RMS:  $\leq \lambda/4$  @ 633nm
7. ROHS COMPLIANT

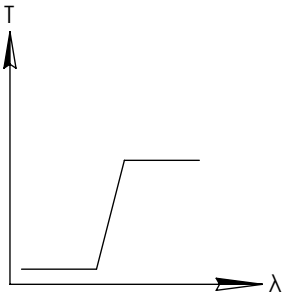
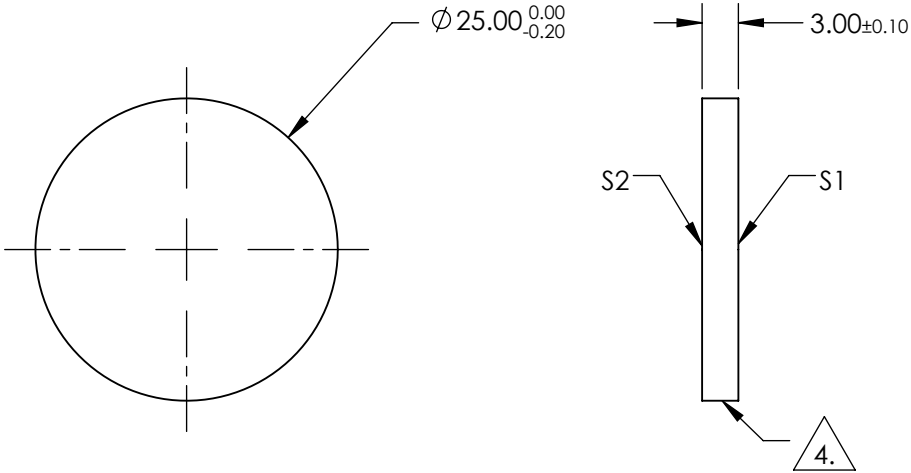
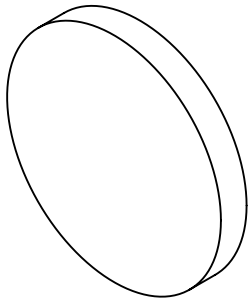

LONGPASS FILTER

SPECIFICATIONS SUBJECT TO CHANGE WITHOUT NOTICE  
DIMENSIONS ARE FOR REFERENCE ONLY

REV A	S1	S2
SHAPE	PLANO	PLANO
SURFACE QUALITY	40-20	40-20
CLEAR APERTURE	>80%	>80%
BEVEL	PROTECTIVE AS NEEDED	PROTECTIVE AS NEEDED

THIRD ANGLE PROJECTION	
ALL DIMS IN	mm

**Edmund Optics®**

TITLE	Ø25mm, 750nm, HIGH PERFORMANCE LONGPASS FILTER
DWG NO	66234
SHEET 1 OF 1	

**FOR INFORMATION ONLY:  
DO NOT MANUFACTURE  
PARTS TO THIS DRAWING**

NOTES:

1. SUBSTRATE
2. SURFACE S2 TO BE PARALLEL WITH SURFACE S1 TO WITHIN 5 arcsec
3. COATING (APPLY ACROSS COATING APERTURE)

S1: HARD DIELECTRIC SPUTTERED  
T(avg): ≥91% FROM 815 - 1650nm @ 0° AOI  
T(avg): ≤0.01% FROM 200 - 785nm @ 0° AOI  
T(abs): =50% FOR 800±8nm @ 0° AOI

S2:SINGLE LAYER MgF2

4. FINE GRIND SURFACE

5. POWER, IRREGULARITY, AND SURFACE QUALITY SPECIFICATIONS  
APPLY ACROSS CLEAR APERTURE
6. TRANSMITTED WAVEFRONT DISTORTION, RMS: ≤λ/4 @ 633nm
7. ROHS COMPLIANT

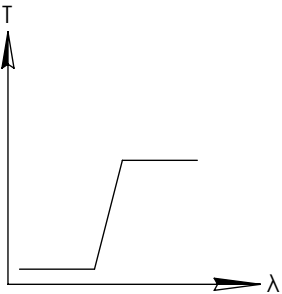
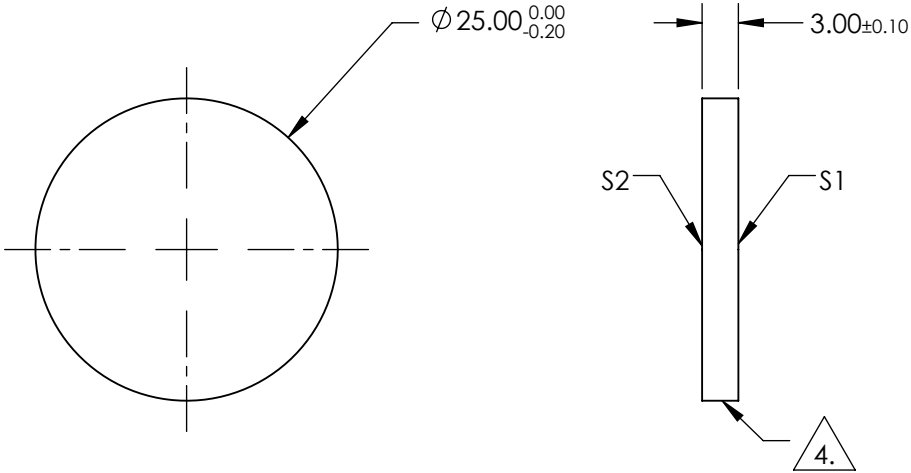
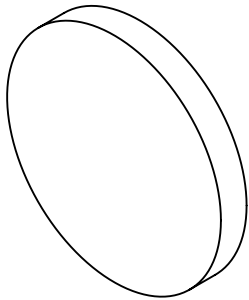

LONGPASS FILTER

SPECIFICATIONS SUBJECT TO CHANGE WITHOUT NOTICE  
DIMENSIONS ARE FOR REFERENCE ONLY

REV A	S1	S2
SHAPE	PLANO	PLANO
SURFACE QUALITY	40-20	40-20
CLEAR APERTURE	>80%	>80%
BEVEL	PROTECTIVE AS NEEDED	PROTECTIVE AS NEEDED



ALL DIMS IN mm

**Edmund Optics®**

TITLE

Ø25mm, 800nm, HIGH PERFORMANCE  
LONGPASS FILTER

DWG NO

66235

SHEET  
1 OF 1

**FOR INFORMATION ONLY:  
DO NOT MANUFACTURE  
PARTS TO THIS DRAWING**

NOTES:

1. SUBSTRATE
2. SURFACE S2 TO BE PARALLEL WITH SURFACE S1 TO WITHIN 5 arcsec
3. COATING (APPLY ACROSS COATING APERTURE)

S1: HARD DIELECTRIC SPUTTERED  
T(avg):  $\geq 91\%$  FROM 865 - 1650nm @ 0° AOI  
T(avg):  $\leq 0.01\%$  FROM 200 - 835nm @ 0° AOI  
T(abs):  $\approx 50\%$  FOR 850 $\pm$ 8.5nm @ 0° AOI

S2: SINGLE LAYER MgF2

4. FINE GRIND SURFACE

5. POWER, IRREGULARITY, AND SURFACE QUALITY SPECIFICATIONS  
APPLY ACROSS CLEAR APERTURE
6. TRANSMITTED WAVEFRONT DISTORTION, RMS:  $\leq \lambda/4$  @ 633nm
7. ROHS COMPLIANT

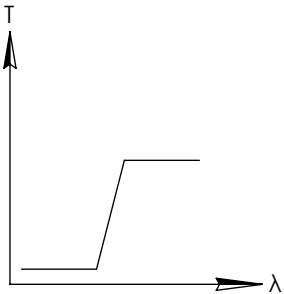
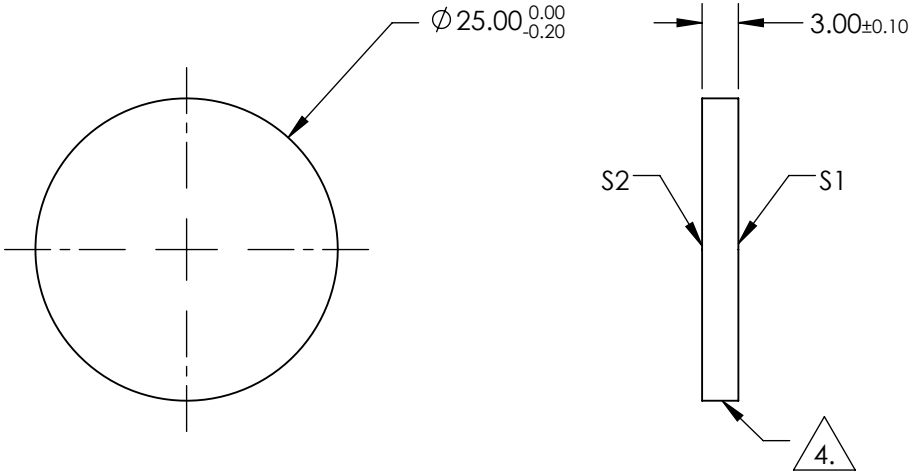
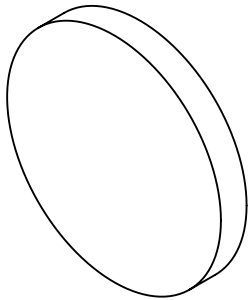

LONGPASS FILTER

SPECIFICATIONS SUBJECT TO CHANGE WITHOUT NOTICE  
DIMENSIONS ARE FOR REFERENCE ONLY

REV A	S1	S2
SHAPE	PLANO	PLANO
SURFACE QUALITY	40-20	40-20
CLEAR APERTURE	>80%	>80%
BEVEL	PROTECTIVE AS NEEDED	PROTECTIVE AS NEEDED



ALL DIMS IN mm

**Edmund Optics®**

TITLE

Ø25mm, 850nm, HIGH PERFORMANCE  
LONGPASS FILTER

DWG NO

66236

SHEET  
1 OF 1

**FOR INFORMATION ONLY:  
DO NOT MANUFACTURE  
PARTS TO THIS DRAWING**

NOTES:

1. SUBSTRATE
2. SURFACE S2 TO BE PARALLEL WITH SURFACE S1 TO WITHIN 5 arcsec
3. COATING (APPLY ACROSS COATING APERTURE)

S1: HARD DIELECTRIC SPUTTERED  
T(avg):  $\geq 91\%$  FROM 915 - 1650nm @ 0° AOI  
T(avg):  $\leq 0.01\%$  FROM 200 - 880nm @ 0° AOI  
T(abs):  $\approx 50\%$  FOR 900 $\pm$ 9nm @ 0° AOI

S2: SINGLE LAYER MgF2

**4.** FINE GRIND SURFACE

5. POWER, IRREGULARITY, AND SURFACE QUALITY SPECIFICATIONS  
APPLY ACROSS CLEAR APERTURE
6. TRANSMITTED WAVEFRONT DISTORTION, RMS:  $\leq \lambda/4$  @ 633nm
7. ROHS COMPLIANT

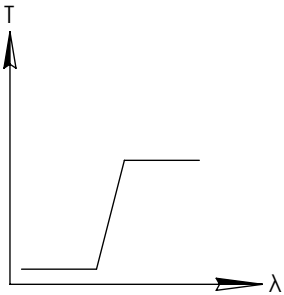
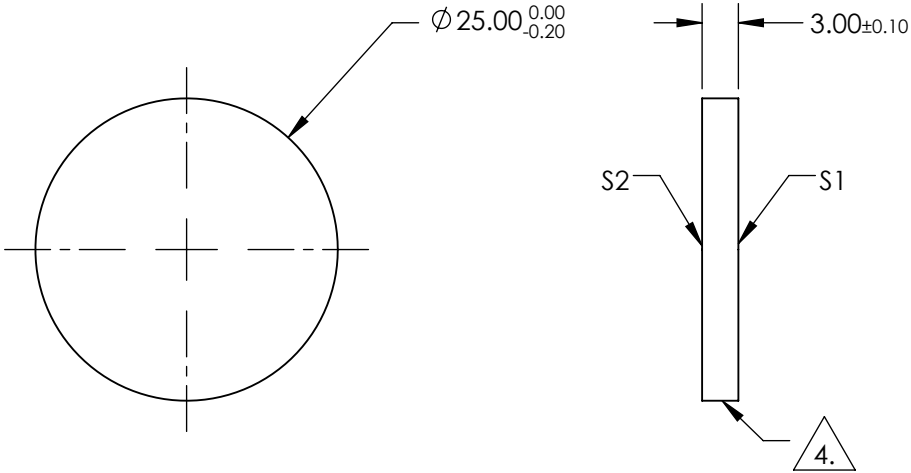
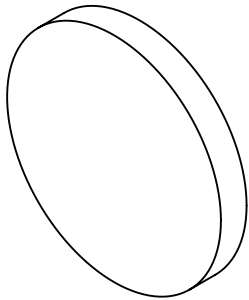

LONGPASS FILTER

SPECIFICATIONS SUBJECT TO CHANGE WITHOUT NOTICE  
DIMENSIONS ARE FOR REFERENCE ONLY

REV A	S1	S2
SHAPE	PLANO	PLANO
SURFACE QUALITY	40-20	40-20
CLEAR APERTURE	>80%	>80%
BEVEL	PROTECTIVE AS NEEDED	PROTECTIVE AS NEEDED



ALL DIMS IN mm

**Edmund Optics®**

TITLE

Ø25mm, 900nm, HIGH PERFORMANCE  
LONGPASS FILTER

DWG NO

66237

SHEET  
1 OF 1



**FOR INFORMATION ONLY:  
DO NOT MANUFACTURE  
PARTS TO THIS DRAWING**

NOTES:

1. SUBSTRATE
2. SURFACE S2 TO BE PARALLEL WITH SURFACE S1 TO WITHIN 5 arcsec
3. COATING (APPLY ACROSS COATING APERTURE)

S1: HARD DIELECTRIC SPUTTERED  
T(avg):  $\geq 91\%$  FROM 965 - 1650nm @ 0° AOI  
T(avg):  $\leq 0.01\%$  FROM 200 - 930nm @ 0° AOI  
T(abs):  $\approx 50\%$  FOR 950 $\pm$ 9.5nm @ 0° AOI

S2: SINGLE LAYER MgF2

4. FINE GRIND SURFACE

5. POWER, IRREGULARITY, AND SURFACE QUALITY SPECIFICATIONS  
APPLY ACROSS CLEAR APERTURE
6. TRANSMITTED WAVEFRONT DISTORTION, RMS:  $\leq \lambda/4$  @ 633nm
7. ROHS COMPLIANT

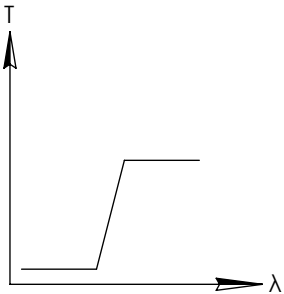
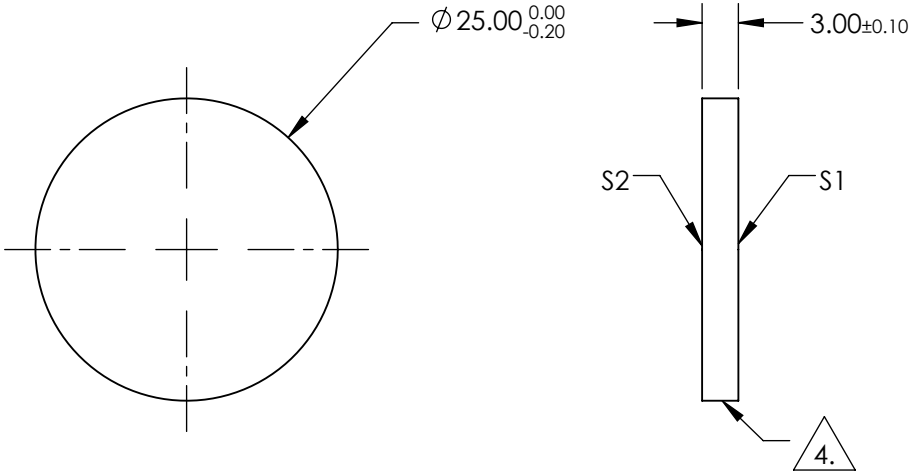
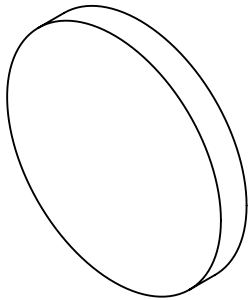

LONGPASS FILTER

SPECIFICATIONS SUBJECT TO CHANGE WITHOUT NOTICE  
DIMENSIONS ARE FOR REFERENCE ONLY

REV A	S1	S2
SHAPE	PLANO	PLANO
SURFACE QUALITY	40-20	40-20
CLEAR APERTURE	>80%	>80%
BEVEL	PROTECTIVE AS NEEDED	PROTECTIVE AS NEEDED

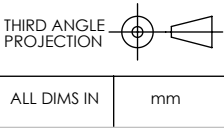

TITLE	Ø25mm, 950nm, HIGH PERFORMANCE LONGPASS FILTER		
DWG NO	66238	SHEET 1 OF 1	

**FOR INFORMATION ONLY:  
DO NOT MANUFACTURE  
PARTS TO THIS DRAWING**

NOTES:

1. SUBSTRATE
2. SURFACE S2 TO BE PARALLEL WITH SURFACE S1 TO WITHIN 5 arcsec
3. COATING (APPLY ACROSS COATING APERTURE)

S1: HARD DIELECTRIC SPUTTERED  
T(avg):  $\geq 91\%$  FROM 1020 - 1650nm @ 0° AOI  
T(avg):  $\leq 0.01\%$  FROM 200 - 980nm @ 0° AOI  
T(abs):  $\approx 50\%$  FOR 1000 $\pm$ 10nm @ 0° AOI

S2: SINGLE LAYER MgF2

4. FINE GRIND SURFACE

5. POWER, IRREGULARITY, AND SURFACE QUALITY SPECIFICATIONS  
APPLY ACROSS CLEAR APERTURE
6. TRANSMITTED WAVEFRONT DISTORTION, RMS:  $\leq \lambda/4$  @ 633nm
7. ROHS COMPLIANT

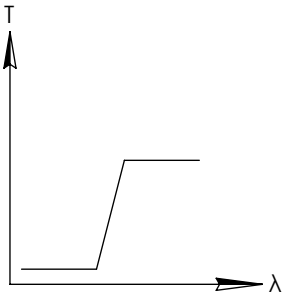
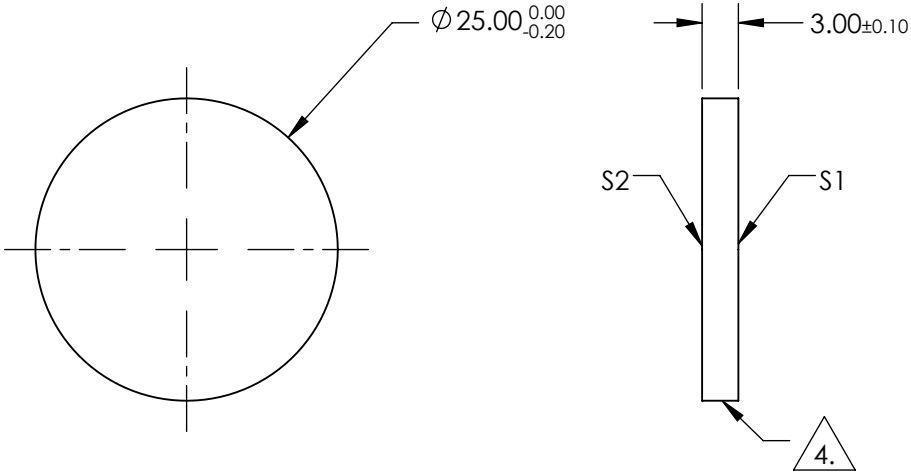
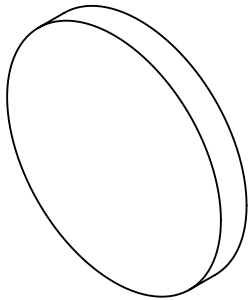

LONGPASS FILTER

SPECIFICATIONS SUBJECT TO CHANGE WITHOUT NOTICE  
DIMENSIONS ARE FOR REFERENCE ONLY

REV A	S1	S2
SHAPE	PLANO	PLANO
SURFACE QUALITY	40-20	40-20
CLEAR APERTURE	>80%	>80%
BEVEL	PROTECTIVE AS NEEDED	PROTECTIVE AS NEEDED



ALL DIMS IN mm

**Edmund Optics®**

TITLE

Ø25mm, 1000nm, HIGH PERFORMANCE  
LONGPASS FILTER

DWG NO

66239

SHEET  
1 OF 1

**FOR INFORMATION ONLY:  
DO NOT MANUFACTURE  
PARTS TO THIS DRAWING**

NOTES:

1. SUBSTRATE
2. SURFACE S2 TO BE PARALLEL WITH SURFACE S1 TO WITHIN 5 arcsec
3. COATING (APPLY ACROSS COATING APERTURE)

S1: HARD DIELECTRIC SPUTTERED  
T(avg): ≥91% FROM 1070 - 1650nm @ 0° AOI  
T(avg): ≤0.01% FROM 200 - 1030nm @ 0° AOI  
T(abs): =50% FOR 1050±10.5nm @ 0° AOI

S2:SINGLE LAYER MgF2

4. FINE GRIND SURFACE

5. POWER, IRREGULARITY, AND SURFACE QUALITY SPECIFICATIONS  
APPLY ACROSS CLEAR APERTURE
6. TRANSMITTED WAVEFRONT DISTORTION, RMS: ≤λ/4 @ 633nm
7. ROHS COMPLIANT

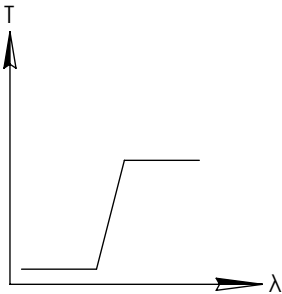
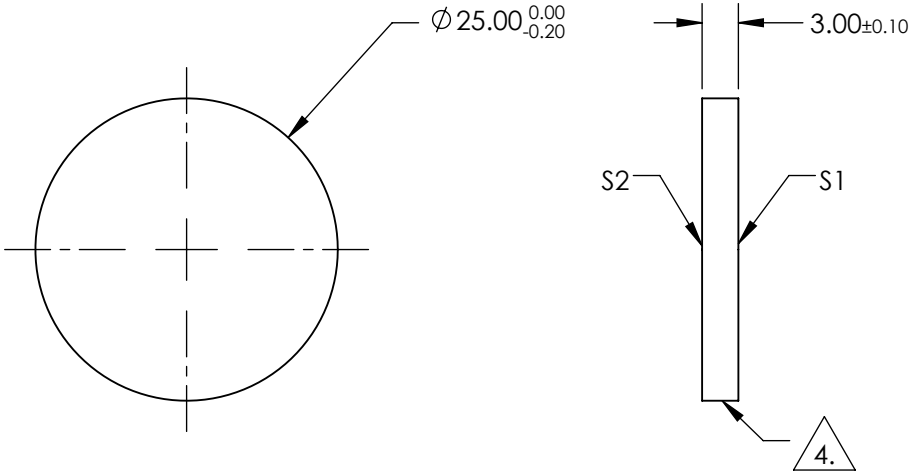
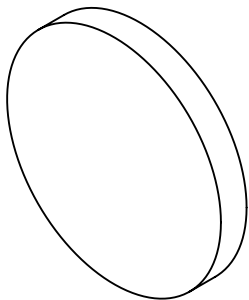

LONGPASS FILTER

SPECIFICATIONS SUBJECT TO CHANGE WITHOUT NOTICE  
DIMENSIONS ARE FOR REFERENCE ONLY

REV A	S1	S2
SHAPE	PLANO	PLANO
SURFACE QUALITY	40-20	40-20
CLEAR APERTURE	>80%	>80%
BEVEL	PROTECTIVE AS NEEDED	PROTECTIVE AS NEEDED

THIRD ANGLE PROJECTION		Edmund Optics®	
ALL DIMS IN mm		TITLE	Ø25mm, 1050nm, HIGH PERFORMANCE LONGPASS FILTER
		DWG NO	66240
		SHEET 1 OF 1	

**FOR INFORMATION ONLY:  
DO NOT MANUFACTURE  
PARTS TO THIS DRAWING**

NOTES:

- 1. SUBSTRATE
- 2. SURFACE S2 TO BE PARALLEL WITH SURFACE S1 TO WITHIN 5 arcsec
- 3. COATING (APPLY ACROSS COATING APERTURE)

S1: HARD DIELECTRIC SPUTTERED  
T(avg): ≥91% FROM 1120 - 1650nm @ 0° AOI  
T(avg): ≤0.01% FROM 200 - 1080nm @ 0° AOI  
T(abs): =50% FOR 1100±11nm @ 0° AOI

S2:SINGLE LAYER MgF2

4. FINE GRIND SURFACE

- 5. POWER, IRREGULARITY, AND SURFACE QUALITY SPECIFICATIONS  
APPLY ACROSS CLEAR APERTURE
- 6. TRANSMITTED WAVEFRONT DISTORTION, RMS: ≤λ/4 @ 633nm
- 7. ROHS COMPLIANT

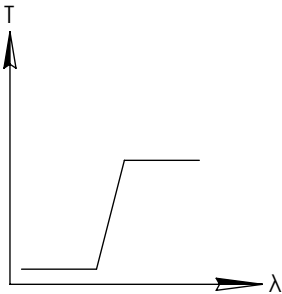
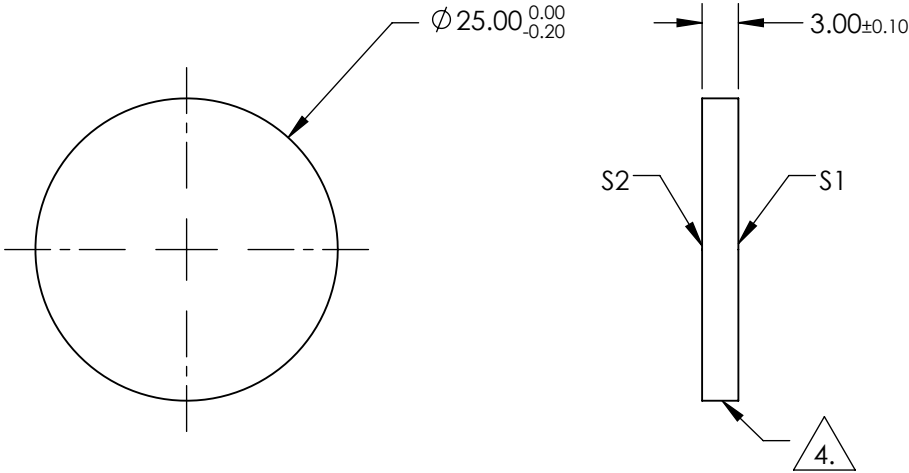
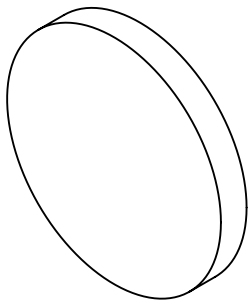

LONGPASS FILTER

SPECIFICATIONS SUBJECT TO CHANGE WITHOUT NOTICE  
DIMENSIONS ARE FOR REFERENCE ONLY

REV A	S1	S2
SHAPE	PLANO	PLANO
SURFACE QUALITY	40-20	40-20
CLEAR APERTURE	>80%	>80%
BEVEL	PROTECTIVE AS NEEDED	PROTECTIVE AS NEEDED

THIRD ANGLE PROJECTION		Edmund Optics®	
ALL DIMS IN mm		TITLE	Ø25mm, 1100nm, HIGH PERFORMANCE LONGPASS FILTER
		DWG NO	66241
		SHEET 1 OF 1	