

Standard 1.5X Magnification, InfiniTube

#65-608



Standard (with no In-Line Attachment), InfiniTube, #56-125

이 in-line assembly 시스템은 infinite-conjugate 대물렌즈를 CCD 카메라에 [Mitutoyo](#)나 [Achrovid](#)의 긴 working-distance 대물렌즈를 마운트하기 위해 사용하여 보통 비디오 렌즈들은 없는 예로 50X의 배율을 줍니다. InfiniTube™ 시스템은 여러 형태로 배열이 가능합니다. Backlight이나 directional illumination와 같은 다른 곳으로부터의 illumination (InfiniTube™ [#56-125](#))를 사용하는 용도에 홀로 쓰일 수 있습니다.

General

Model Number:	InfiniTube™ Standard 1.5X
Type:	Fixed Magnification Lens

Optical Properties

Primary Magnification PMAG:	Objective Required
-----------------------------	--------------------

Threading & Mounting

Mount:	C-Mount
--------	---------

Infinitube™ Filter Holder

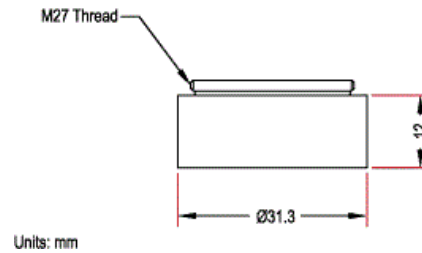

Infinitube™ Standard

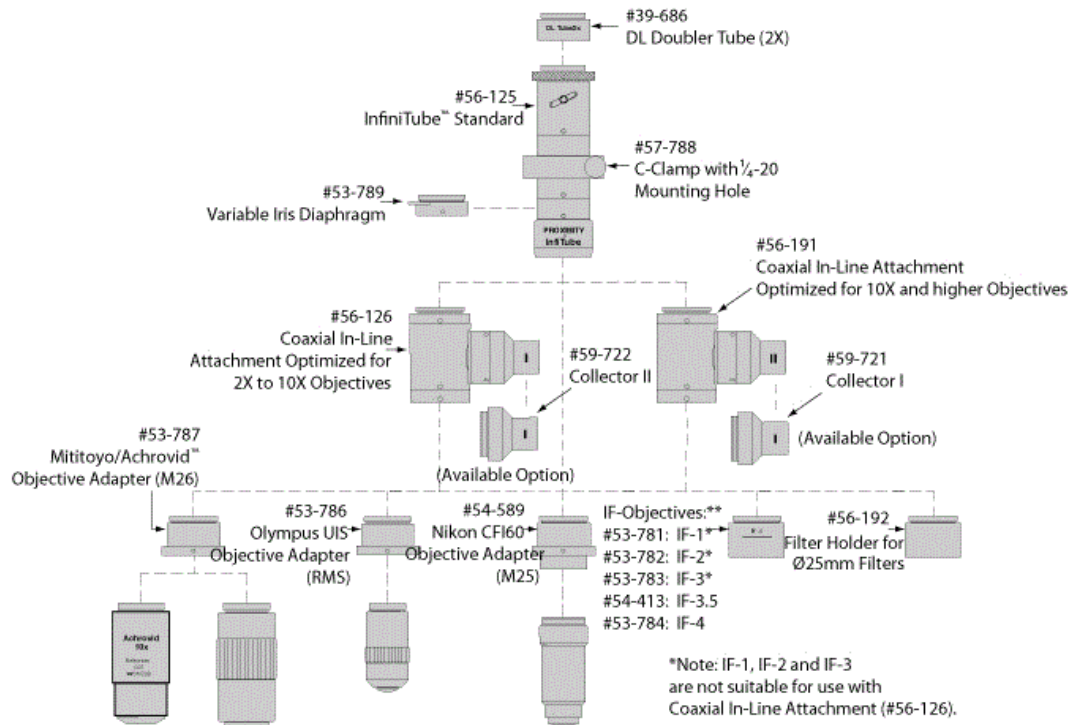
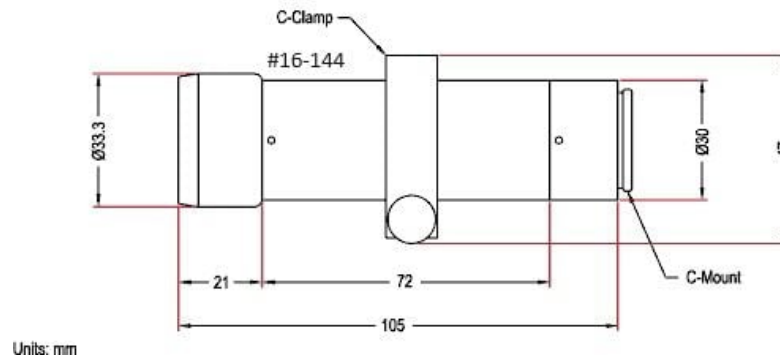

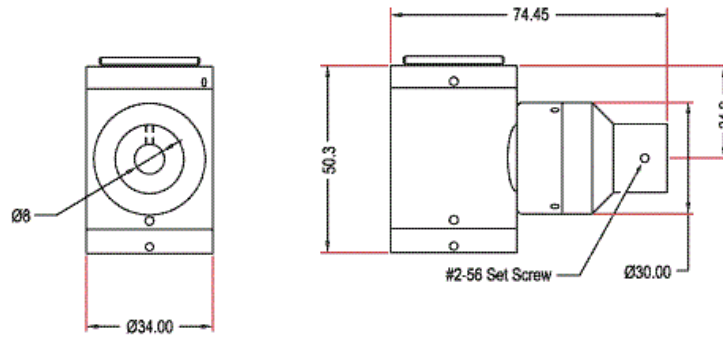
InfiniTube™ In-Line Attachment

Units: mm



June 17, 2025

To Whom It May Concern,

This document certifies that the product stated below has been reviewed as requested by Edmund Optics:

재고 번호	제품설명
65-608	Standard 1.5X Magnification, InfiniTube

This item is EU RoHS (2015/863/EU) compliant without the use of exemptions.

This certification means that:

- EO's suppliers have confirmed the material composition of this product.
- EO has implemented rigorous procedures to document this compliance.
- The information provided may, or may not, be based upon actual test data, or on information from our Vendors, Raw Material Suppliers or Subcontractors.



Jay Budd, Director of Corporate Compliance

June 17, 2025

 Edmund Optics Inc. - 101 E Gloucester Pike, Barrington, NJ 08007 | 1-800-363-1992 | Compliance@edmundoptics.com



June 17, 2025

To Whom It May Concern,

This document certifies that the product stated below has been reviewed as requested by Edmund Optics:

재고 번호	제품설명
65-608	Standard 1.5X Magnification, InfiniTube

This item does not contain any of the substances listed on the Reach SVHC list as of 10 June 2022 in quantities exceeding 0.1% weight by weight.

Please note the following:

- Entry 11 of Annex V of the REACH regulation EC 1907/2006 as amended by regulation 987/2008, exempts "non-hazardous" glass components from registration.
- Items considered to be packing materials and which do not form part of, or are not required for the operation of, the product, are not considered to be within scope of this declaration.
- EO does not routinely analyze products for substances not purposely added or specified within the design specifications, drawings and assembly procedures.

This certification means that:

- EO's suppliers have confirmed the material composition of this product.
- EO has implemented rigorous procedures to document this compliance.
- The information provided may, or may not, be based upon actual test data, or on information from our Vendors, Raw Material Suppliers or Subcontractors.



Jay Budd, Director of Corporate Compliance
June 17, 2025

Edmund Optics Inc. - 101 E Gloucester Pike, Barrington, NJ 08007 | 1-800-363-1992 | Compliance@edmundoptics.com



June 17, 2025

재고 번호

65-608

제품설명

Standard 1.5X Magnification, InfiniTube

Edmund Optics certifies that all articles included in this shipment are in compliance with the terms and conditions of this order. The company also certifies that the articles included in this shipment are in accordance to all agreed upon specifications and quality assurance provisions. Please call 1-800-363-1992 should any questions arise from this shipment.



Jeff Harvey- EVP of Operations

